

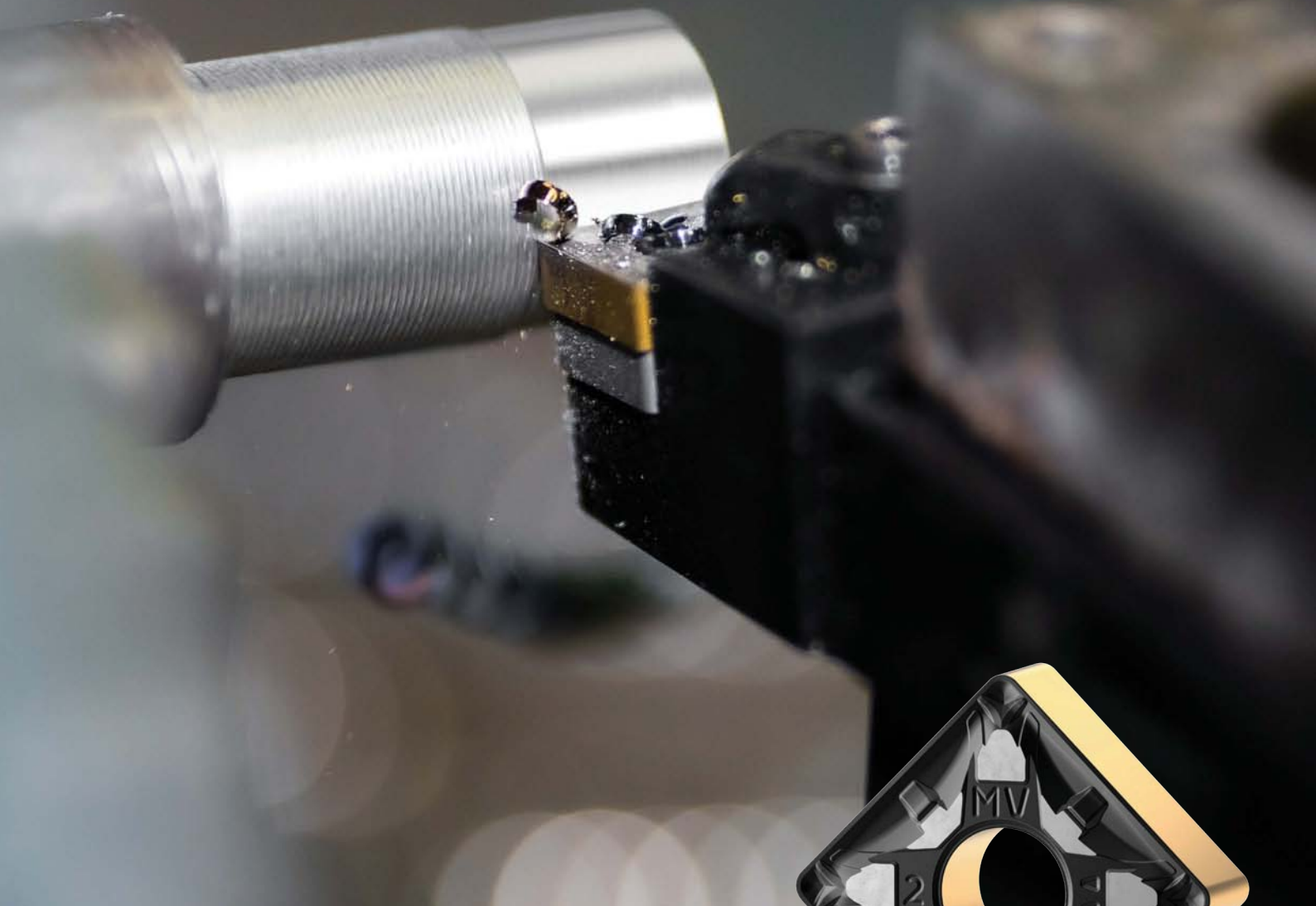

KCP25C

Drehsorte für Stahl mit KENGold™
CVD-BESCHICHTUNGSTECHNOLOGIE



Zuverlässige Leistung
beim Drehen



Anwendungen

Schruppen Mittlere Bearbeitung
Schlichten

Werkstoffe

P Stähle

Branchen

 Automobilindustrie

 Öl- und Gasindustrie

 Allg. Maschinenbau

 Wind und Solar

KCP25C bietet eine verbesserte Zähigkeit und Abriebfestigkeit sowie eine gleichbleibende und wiederholbare Leistung für höhere Zeitspannungsvolumen durch erhöhte Schnittgeschwindigkeiten.

EIGENSCHAFTEN UND VORTEILE

- Zuverlässige Leistung beim Drehen
- Keine ungenutzten Schneiden durch leichte Verschleißerkennung
- Erhöht die Genauigkeit und Produktivität und gewährleistet gleichbleibende Standzeiten

ISO-Wendeschneidplattentypen



Proprietäre Wendeschneidplattentypen



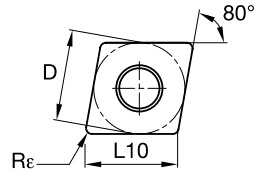
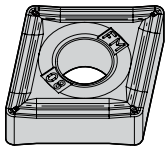

- Primär
- Sekundär

P	●
M	○
K	○
N	○
S	○
H	○

Kenloc™ • CNMG-Wendeschnleidplatte • Negativ • FM

ISO	ANSI	D		L10		Rε		KCP25C
Katalognummer	Katalognummer	mm	Zoll	mm	Zoll	mm	Zoll	
CNMG120412FM	CNMG433FM	12.70	0.500	12.90	0.508	1.2	0.047	●

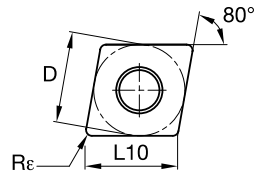
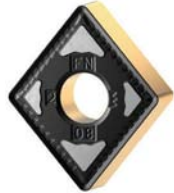

- Primär
- Sekundär

P	●
M	○
K	○
N	○
S	○
H	○

Kenloc™ • CNMG-Wendeschnleidplatte • Negativ • FN

ISO	ANSI	D		L10		Rε		KCP25C
Katalognummer	Katalognummer	mm	Zoll	mm	Zoll	mm	Zoll	
CNMG120404FN	CNMG431FN	12.70	0.500	12.90	0.508	0.4	0.016	●
CNMG120408FN	CNMG432FN	12.70	0.500	12.90	0.508	0.8	0.031	●
CNMG120412FN	CNMG433FN	12.70	0.500	12.90	0.508	1.2	0.047	●

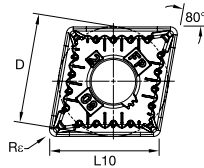
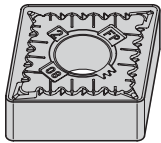

- Primär
- Sekundär

P	●
M	○
K	○
N	○
S	○
H	○

Kenloc™ • CNMG-Wendeschnleidplatte • Negativ • FP

ISO	ANSI	D		L10		Rε		KCP25C
Katalognummer	Katalognummer	mm	Zoll	mm	Zoll	mm	Zoll	
CNMG120404FP	CNMG431FP	12.70	0.500	12.90	0.508	0.4	0.016	●
CNMG120408FP	CNMG432FP	12.70	0.500	12.90	0.508	0.8	0.031	●

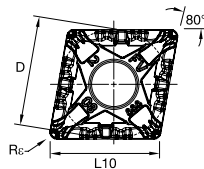

- Primär
- Sekundär

P	●
M	○
K	○
N	○
S	○
H	○

Kenloc™ • CNMG-Wendeschnleidplatte • Negativ • FV

ISO	ANSI	D		L10		R		KCP25C
Katalognummer	Katalognummer	mm	Zoll	mm	Zoll	mm	Zoll	
CNMG120404FV	CNMG431FV	12.70	0.500	12.90	0.508	0.4	0.016	●
CNMG120408FV	CNMG432FV	12.70	0.500	12.90	0.508	0.8	0.031	●
CNMG120412FV	CNMG433FV	12.70	0.500	12.90	0.508	1.2	0.047	●

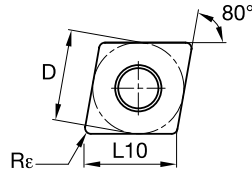
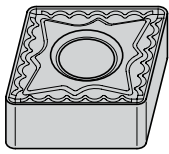

- Primär
- Sekundär

P	Blue	●
M	Yellow	○
K	Red	○
N	Green	○
S	Orange	○
H	Grey	○

Kenloc™ • CNMG-Wendeschnidplatte • Negativ • MG

ISO Katalognummer	ANSI Katalognummer	D		L10		Rε		● Primär ○ Sekundär
		mm	Zoll	mm	Zoll	mm	Zoll	
CNMG120404MG	CNMG431MG	12.70	0.500	12.90	0.508	0.4	0.016	●
CNMG120408MG	CNMG432MG	12.70	0.500	12.90	0.508	0.8	0.031	●
CNMG160612MG	CNMG543MG	15.88	0.625	16.12	0.635	1.2	0.047	●
CNMG190612MG	CNMG643MG	19.05	0.750	19.34	0.762	1.2	0.047	●

KCP25C

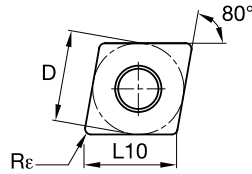
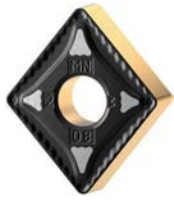

- Primär
- Sekundär

P	Blue	●
M	Yellow	○
K	Red	○
N	Green	○
S	Orange	○
H	Grey	○

Kenloc™ • CNMG-Wendeschnidplatte • Negativ • MN

ISO Katalognummer	ANSI Katalognummer	D		L10		Rε		● Primär ○ Sekundär
		mm	Zoll	mm	Zoll	mm	Zoll	
CNMG090304MN	CNMG321MN	9.53	0.375	9.67	0.381	0.4	0.016	●
CNMG090308MN	CNMG322MN	9.53	0.375	9.67	0.381	0.8	0.031	●
CNMG120404MN	CNMG431MN	12.70	0.500	12.90	0.508	0.4	0.016	●
CNMG120408MN	CNMG432MN	12.70	0.500	12.90	0.508	0.8	0.031	●
CNMG120412MN	CNMG433MN	12.70	0.500	12.90	0.508	1.2	0.047	●
CNMG120416MN	CNMG434MN	12.70	0.500	12.90	0.508	1.6	0.063	●
CNMG160608MN	CNMG542MN	15.88	0.625	16.12	0.635	0.8	0.031	●
CNMG160612MN	CNMG543MN	15.88	0.625	16.12	0.635	1.2	0.047	●
CNMG160616MN	CNMG544MN	15.88	0.625	16.12	0.635	1.6	0.063	●
CNMG190608MN	CNMG642MN	19.05	0.750	19.34	0.762	0.8	0.031	●
CNMG190612MN	CNMG643MN	19.05	0.750	19.34	0.762	1.2	0.047	●
CNMG190616MN	CNMG644MN	19.05	0.750	19.34	0.762	1.6	0.063	●
CNMG190624MN	CNMG646MN	19.05	0.750	19.34	0.762	2.4	0.094	●

KCP25C

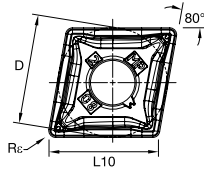
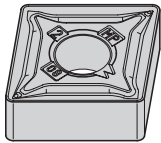

- Primär
- Sekundär

P	Blue	●
M	Yellow	○
K	Red	○
N	Green	○
S	Orange	○
H	Grey	○

Kenloc™ • CNMG-Wendeschnidplatte • Negativ • MP

ISO Katalognummer	ANSI Katalognummer	D		L10		Rε		● Primär ○ Sekundär
		mm	Zoll	mm	Zoll	mm	Zoll	
CNMG120408MP	CNMG432MP	12.70	0.500	12.90	0.508	0.8	0.031	●
CNMG120412MP	CNMG433MP	12.70	0.500	12.90	0.508	1.2	0.047	●

KCP25C

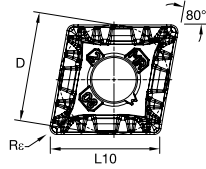
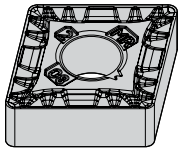

- Primär
- Sekundär

P	Blue	●
M	Yellow	○
K	Red	○
N	Green	○
S	Orange	○
H	Grey	○

Kenloc™ • CNMG-Wendescheidplatte • Negativ • MR

ISO Katalognummer	ANSI Katalognummer	D		L10		R		KCP25C
		mm	Zoll	mm	Zoll	mm	Zoll	
CNMG120408MR	CNMG432MR	12.70	0.500	12.90	0.508	0.8	0.031	●
CNMG120412MR	CNMG433MR	12.70	0.500	12.90	0.508	1.2	0.047	●
CNMG160612MR	CNMG543MR	15.88	0.625	16.12	0.635	1.2	0.047	●
CNMG160616MR	CNMG544MR	15.88	0.625	16.12	0.635	1.6	0.063	●
CNMG190612MR	CNMG643MR	19.05	0.750	19.34	0.762	1.2	0.047	●

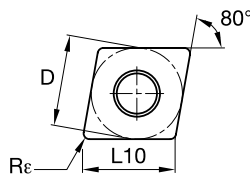

- Primär
- Sekundär

P	Blue	●
M	Yellow	○
K	Red	○
N	Green	○
S	Orange	○
H	Grey	○

Kenloc™ • CNMG-Wendescheidplatte • Negativ • MV

ISO Katalognummer	ANSI Katalognummer	D		L10		Rε		KCP25C
		mm	Zoll	mm	Zoll	mm	Zoll	
CNMG090304MV	CNMG321MV	9.53	0.375	9.67	0.381	0.4	0.016	●
CNMG090308MV	CNMG322MV	9.53	0.375	9.67	0.381	0.8	0.031	●
CNMG120404MV	CNMG431MV	12.70	0.500	12.90	0.508	0.4	0.016	●
CNMG120408MV	CNMG432MV	12.70	0.500	12.90	0.508	0.8	0.031	●
CNMG120412MV	CNMG433MV	12.70	0.500	12.90	0.508	1.2	0.047	●
CNMG120416MV	CNMG434MV	12.70	0.500	12.90	0.508	1.6	0.063	●
CNMG160608MV	CNMG542MV	15.88	0.625	16.12	0.635	0.8	0.031	●
CNMG160612MV	CNMG543MV	15.88	0.625	16.12	0.635	1.2	0.047	●
CNMG160616MV	CNMG544MV	15.88	0.625	16.12	0.635	1.6	0.063	●
CNMG190608MV	CNMG642MV	19.05	0.750	19.34	0.762	0.8	0.031	●
CNMG190612MV	CNMG643MV	19.05	0.750	19.34	0.762	1.2	0.047	●
CNMG190616MV	CNMG644MV	19.05	0.750	19.34	0.762	1.6	0.063	●
CNMG190624MV	CNMG646MV	19.05	0.750	19.34	0.762	2.4	0.094	●

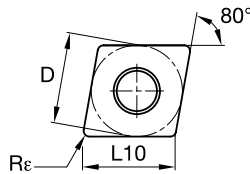
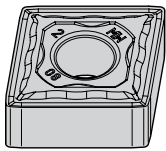

- Primär
- Sekundär

P	Blue	●
M	Yellow	○
K	Red	○
N	Green	○
S	Orange	○
H	Grey	○

Kenloc™ • CNMG-Wendescheidplatte • Negativ • MW

ISO Katalognummer	ANSI Katalognummer	D		L10		Rε		KCP25C
		mm	Zoll	mm	Zoll	mm	Zoll	
CNMG120408MW	CNMG432MW	12.70	0.500	12.90	0.508	0.8	0.031	●
CNMG120412MW	CNMG433MW	12.70	0.500	12.90	0.508	1.2	0.047	●

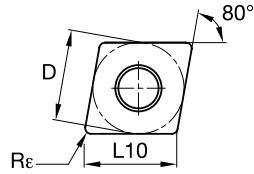
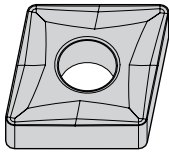

- Primär
- Sekundär

P	●
M	○
K	○
N	○
S	○
H	○

Kenloc™ • CNMG-Wendeschnidplatte • Negativ • RM

ISO	ANSI	D		L10		Rε		KCP25C
Katalognummer	Katalognummer	mm	Zoll	mm	Zoll	mm	Zoll	
CNMG190616RM	CNMG644RM	19.05	0.750	19.34	0.762	1.6	0.063	●
CNMG250924RM	CNMG866RM	25.40	1.000	25.79	1.015	2.4	0.094	●

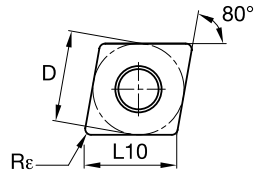

- Primär
- Sekundär

P	●
M	○
K	○
N	○
S	○
H	○

Kenloc™ • CNMG-Wendeschnidplatte • Negativ • RN

ISO	ANSI	D		L10		Rε		KCP25C
Katalognummer	Katalognummer	mm	Zoll	mm	Zoll	mm	Zoll	
CNMG120408RN	CNMG432RN	12.70	0.500	12.90	0.508	0.8	0.031	●
CNMG120412RN	CNMG433RN	12.70	0.500	12.90	0.508	1.2	0.047	●
CNMG120416RN	CNMG434RN	12.70	0.500	12.90	0.508	1.6	0.063	●
CNMG160608RN	CNMG542RN	15.88	0.625	16.12	0.635	0.8	0.031	●
CNMG160612RN	CNMG543RN	15.88	0.625	16.12	0.635	1.2	0.047	●
CNMG160616RN	CNMG544RN	15.88	0.625	16.12	0.635	1.6	0.063	●
CNMG190608RN	CNMG642RN	19.05	0.750	19.34	0.762	0.8	0.031	●
CNMG190612RN	CNMG643RN	19.05	0.750	19.34	0.762	1.2	0.047	●
CNMG190616RN	CNMG644RN	19.05	0.750	19.34	0.762	1.6	0.063	●
CNMG190624RN	CNMG646RN	19.05	0.750	19.34	0.762	2.4	0.094	●

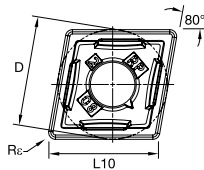
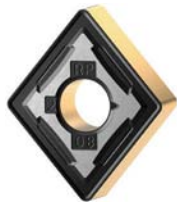

- Primär
- Sekundär

P	●
M	○
K	○
N	○
S	○
H	○

Kenloc™ • CNMG-Wendeschnidplatte • Negativ • RP

ISO	ANSI	D		L10		Rε		KCP25C
Katalognummer	Katalognummer	mm	Zoll	mm	Zoll	mm	Zoll	
CNMG120404RP	CNMG431RP	12.70	0.500	12.90	0.508	0.4	0.016	●
CNMG120408RP	CNMG432RP	12.70	0.500	12.90	0.508	0.8	0.031	●
CNMG120412RP	CNMG433RP	12.70	0.500	12.90	0.508	1.2	0.047	●
CNMG120416RP	CNMG434RP	12.70	0.500	12.90	0.508	1.6	0.063	●
CNMG160608RP	CNMG542RP	15.88	0.625	16.12	0.635	0.8	0.031	●
CNMG160612RP	CNMG543RP	15.88	0.625	16.12	0.635	1.2	0.047	●
CNMG160616RP	CNMG544RP	15.88	0.625	16.12	0.635	1.6	0.063	●
CNMG190612RP	CNMG643RP	19.05	0.750	19.34	0.762	1.2	0.047	●
CNMG190616RP	CNMG644RP	19.05	0.750	19.34	0.762	1.6	0.063	●

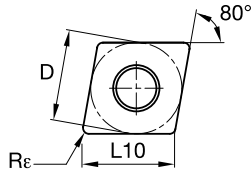

- Primär
- Sekundär

P	Blue	●
M	Yellow	○
K	Red	○
N	Green	○
S	Orange	○
H	Grey	○

Kenloc™ • CNMM-Wendeschneidplatte • Negativ • RH

ISO Katalognummer	ANSI Katalognummer	D		L10		Rε		● Primär ○ Sekundär
		mm	Zoll	mm	Zoll	mm	Zoll	
CNMM190616RH	CNMM644RH	19.05	0.750	19.34	0.762	1.6	0.063	●
CNMM190624RH	CNMM646RH	19.05	0.750	19.34	0.762	2.4	0.094	●
CNMM250924RH	CNMM866RH	25.40	1.000	25.79	1.015	2.4	0.094	●

KCP25C

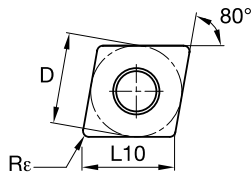
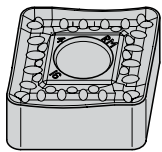

- Primär
- Sekundär

P	Blue	●
M	Yellow	○
K	Red	○
N	Green	○
S	Orange	○
H	Grey	○

Kenloc™ • CNMM-Wendeschneidplatte • Negativ • RM

ISO Katalognummer	ANSI Katalognummer	D		L10		Rε		● Primär ○ Sekundär
		mm	Zoll	mm	Zoll	mm	Zoll	
CNMM120408RM	CNMM432RM	12.70	0.500	12.90	0.508	0.8	0.031	●
CNMM120412RM	CNMM433RM	12.70	0.500	12.90	0.508	1.2	0.047	●
CNMM120416RM	CNMM434RM	12.70	0.500	12.90	0.508	1.6	0.063	●
CNMM160612RM	CNMM543RM	15.88	0.625	16.12	0.635	1.2	0.047	●
CNMM160616RM	CNMM544RM	15.88	0.625	16.12	0.635	1.6	0.063	●
CNMM160624RM	CNMM546RM	15.88	0.625	16.12	0.635	2.4	0.094	●
CNMM190612RM	CNMM643RM	19.05	0.750	19.34	0.762	1.2	0.047	●
CNMM190616RM	CNMM644RM	19.05	0.750	19.34	0.762	1.6	0.063	●
CNMM190624RM	CNMM646RM	19.05	0.750	19.34	0.762	2.4	0.094	●
CNMM250924RM	CNMM866RM	25.40	1.000	25.79	1.015	2.4	0.094	●

KCP25C

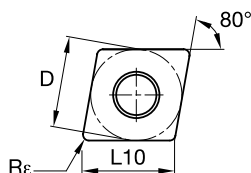
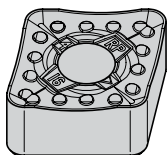

- Primär
- Sekundär

P	Blue	●
M	Yellow	○
K	Red	○
N	Green	○
S	Orange	○
H	Grey	○

Kenloc™ • CNMM-Wendeschneidplatte • Negativ • RP

ISO Katalognummer	ANSI Katalognummer	D		L10		Rε		● Primär ○ Sekundär
		mm	Zoll	mm	Zoll	mm	Zoll	
CNMM120408RP	CNMM432RP	12.70	0.500	12.90	0.508	0.8	0.031	●
CNMM120412RP	CNMM433RP	12.70	0.500	12.90	0.508	1.2	0.047	●
CNMM120416RP	CNMM434RP	12.70	0.500	12.90	0.508	1.6	0.063	●
CNMM160608RP	CNMM542RP	15.88	0.625	16.12	0.635	0.8	0.031	●
CNMM160612RP	CNMM543RP	15.88	0.625	16.12	0.635	1.2	0.047	●
CNMM160616RP	CNMM544RP	15.88	0.625	16.12	0.635	1.6	0.063	●
CNMM190612RP	CNMM643RP	19.05	0.750	19.34	0.762	1.2	0.047	●
CNMM190616RP	CNMM644RP	19.05	0.750	19.34	0.762	1.6	0.063	●
CNMM190624RP	CNMM646RP	19.05	0.750	19.34	0.762	2.4	0.094	●
CNMM250924RP	CNMM866RP	25.40	1.000	25.79	1.015	2.4	0.094	●

KCP25C

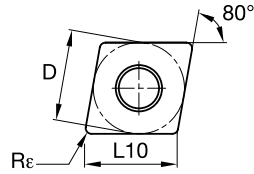
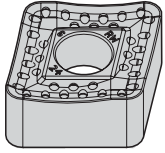

- Primär
- Sekundär

P	●
M	○
K	○
N	○
S	○
H	○

Kenloc™ • CNMM-Wendescheidplatte • Negativ • RW

ISO	ANSI	D		L10		Rε		KCP25C
Katalognummer	Katalognummer	mm	Zoll	mm	Zoll	mm	Zoll	
CNMM190624RW	CNMM646RW	19.05	0.750	19.34	0.762	2.4	0.094	●

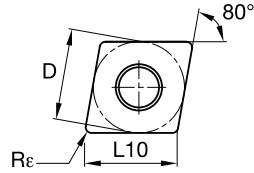
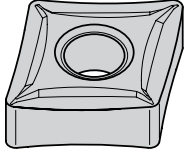

- Primär
- Sekundär

P	●
M	○
K	○
N	○
S	○
H	○

Kenloc™ • CNMP-Wendescheidplatte • Negativ • K

ISO	ANSI	D		L10		Rε		KCP25C
Katalognummer	Katalognummer	mm	Zoll	mm	Zoll	mm	Zoll	
CNMP120404K	CNMP431K	12.70	0.500	12.90	0.508	0.4	0.016	●
CNMP120408K	CNMP432K	12.70	0.500	12.90	0.508	0.8	0.031	●

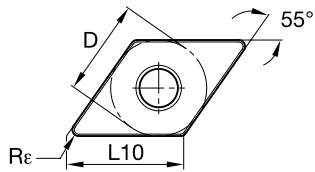
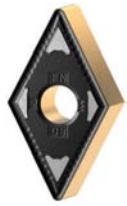

- Primär
- Sekundär

P	●
M	○
K	○
N	○
S	○
H	○

Kenloc™ • DNMG-Wendescheidplatte • Negativ • FN

ISO	ANSI	D		L10		R		KCP25C
Katalognummer	Katalognummer	mm	Zoll	mm	Zoll	mm	Zoll	
DNMG110404FN	DNMG331FN	9.53	0.375	11.63	0.458	0.4	0.016	●
DNMG110408FN	DNMG332FN	9.53	0.375	11.63	0.458	0.8	0.031	●
DNMG150404FN	DNMG431FN	12.70	0.500	15.50	0.610	0.4	0.016	●
DNMG150408FN	DNMG432FN	12.70	0.500	15.50	0.610	0.8	0.031	●
DNMG150604FN	DNMG441FN	12.70	0.500	15.50	0.610	0.4	0.016	●
DNMG150608FN	DNMG442FN	12.70	0.500	15.50	0.610	0.8	0.031	●

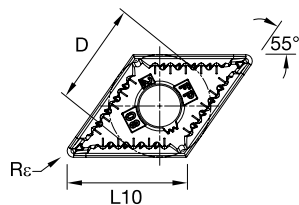
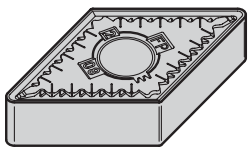

- Primär
- Sekundär

P	●
M	○
K	○
N	○
S	○
H	○

Kenloc™ • DNMG-Wendescheidplatte • Negativ • FP

ISO	ANSI	D		L10		R		KCP25C
Katalognummer	Katalognummer	mm	Zoll	mm	Zoll	mm	Zoll	
DNMG150408FP	DNMG432FP	12.70	0.500	15.50	0.610	0.8	0.031	●
DNMG150608FP	DNMG442FP	12.70	0.500	15.50	0.610	0.8	0.031	●

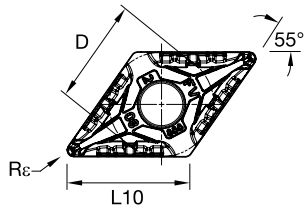

- Primär
- Sekundär

P	Blue	●
M	Yellow	○
K	Red	○
N	Green	○
S	Orange	○
H	Grey	○

Kenloc™ • DNMG-Wendeschneidplatte • Negativ • FV

ISO Katalognummer	ANSI Katalognummer	D		L10		Rε		KCP25C
		mm	Zoll	mm	Zoll	mm	Zoll	
DNMG110404FV	DNMG331FV	9.53	0.375	11.63	0.458	0.4	0.016	●
DNMG110408FV	DNMG332FV	9.53	0.375	11.63	0.458	0.8	0.031	●
DNMG150404FV	DNMG431FV	12.70	0.500	15.50	0.610	0.4	0.016	●
DNMG150408FV	DNMG432FV	12.70	0.500	15.50	0.610	0.8	0.031	●
DNMG150604FV	DNMG441FV	12.70	0.500	15.50	0.610	0.4	0.016	●
DNMG150608FV	DNMG442FV	12.70	0.500	15.50	0.610	0.8	0.031	●

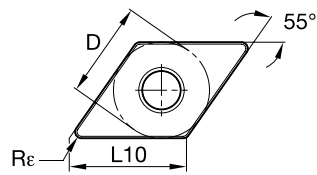
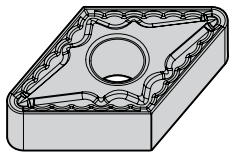

- Primär
- Sekundär

P	Blue	●
M	Yellow	○
K	Red	○
N	Green	○
S	Orange	○
H	Grey	○

Kenloc™ • DNMG-Wendeschneidplatte • Negativ • MG

ISO Katalognummer	ANSI Katalognummer	D		L10		Rε		KCP25C
		mm	Zoll	mm	Zoll	mm	Zoll	
DNMG150608MG	DNMG442MG	12.70	0.500	15.50	0.610	0.8	0.031	●
DNMG150612MG	DNMG443MG	12.70	0.500	15.50	0.610	1.2	0.047	●

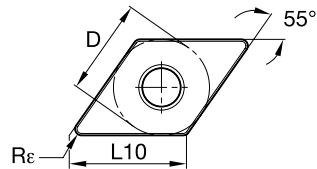

- Primär
- Sekundär

P	Blue	●
M	Yellow	○
K	Red	○
N	Green	○
S	Orange	○
H	Grey	○

Kenloc™ • DNMG-Wendeschneidplatte • Negativ • MN

ISO Katalognummer	ANSI Katalognummer	D		L10		Rε		KCP25C
		mm	Zoll	mm	Zoll	mm	Zoll	
DNMG110404MN	DNMG331MN	9.53	0.375	11.63	0.458	0.4	0.016	●
DNMG110408MN	DNMG332MN	9.53	0.375	11.63	0.458	0.8	0.031	●
DNMG110412MN	DNMG333MN	9.53	0.375	11.63	0.458	1.2	0.047	●
DNMG150404MN	DNMG431MN	12.70	0.500	15.50	0.610	0.4	0.016	●
DNMG150408MN	DNMG432MN	12.70	0.500	15.50	0.610	0.8	0.031	●
DNMG150412MN	DNMG433MN	12.70	0.500	15.50	0.610	1.2	0.047	●
DNMG150604MN	DNMG441MN	12.70	0.500	15.50	0.610	0.4	0.016	●
DNMG150608MN	DNMG442MN	12.70	0.500	15.50	0.610	0.8	0.031	●
DNMG150612MN	DNMG443MN	12.70	0.500	15.50	0.610	1.2	0.047	●

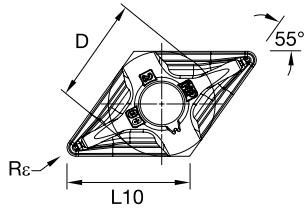
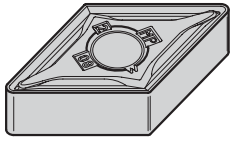

- Primär
- Sekundär

P	Blue	●
M	Yellow	○
K	Red	○
N	Green	○
S	Orange	○
H	Grey	○

Kenloc™ • DNMG-Wendeschneidplatte • Negativ • MP

ISO	ANSI	D		L10		Rε		KCP25C
Katalognummer	Katalognummer	mm	Zoll	mm	Zoll	mm	Zoll	
DNMG150408MP	DNMG432MP	12.70	0.500	15.50	0.610	0.8	0.031	●
DNMG150608MP	DNMG442MP	12.70	0.500	15.50	0.610	0.8	0.031	●

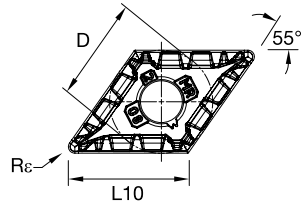
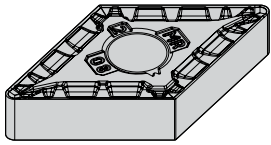

- Primär
- Sekundär

P	Blue	●
M	Yellow	○
K	Red	○
N	Green	○
S	Orange	○
H	Grey	○

Kenloc™ • DNMG-Wendeschneidplatte • Negativ • MR

ISO	ANSI	D		L10		Rε		KCP25C
Katalognummer	Katalognummer	mm	Zoll	mm	Zoll	mm	Zoll	
DNMG110408MR	DNMG332MR	9.53	0.375	11.63	0.458	0.8	0.031	●
DNMG150408MR	DNMG432MR	12.70	0.500	15.50	0.610	0.8	0.031	●
DNMG150608MR	DNMG442MR	12.70	0.500	15.50	0.610	0.8	0.031	●
DNMG150612MR	DNMG443MR	12.70	0.500	15.50	0.610	1.2	0.047	●
DNMG150616MR	DNMG444MR	12.70	0.500	15.50	0.610	1.6	0.063	●

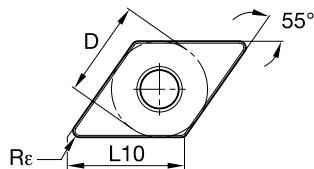

- Primär
- Sekundär

P	Blue	●
M	Yellow	○
K	Red	○
N	Green	○
S	Orange	○
H	Grey	○

Kenloc™ • DNMG-Wendeschneidplatte • Negativ • MV

ISO	ANSI	D		L10		Rε		KCP25C
Katalognummer	Katalognummer	mm	Zoll	mm	Zoll	mm	Zoll	
DNMG110404MV	DNMG331MV	9.53	0.375	11.63	0.458	0.4	0.016	●
DNMG110408MV	DNMG332MV	9.53	0.375	11.63	0.458	0.8	0.031	●
DNMG110412MV	DNMG333MV	9.53	0.375	11.63	0.458	1.2	0.047	●
DNMG150404MV	DNMG431MV	12.70	0.500	15.50	0.610	0.4	0.016	●
DNMG150408MV	DNMG432MV	12.70	0.500	15.50	0.610	0.8	0.031	●
DNMG150412MV	DNMG433MV	12.70	0.500	15.50	0.610	1.2	0.047	●
DNMG150604MV	DNMG441MV	12.70	0.500	15.50	0.610	0.4	0.016	●
DNMG150608MV	DNMG442MV	12.70	0.500	15.50	0.610	0.8	0.031	●
DNMG150612MV	DNMG443MV	12.70	0.500	15.50	0.610	1.2	0.047	●

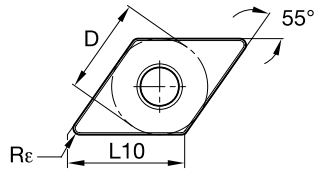
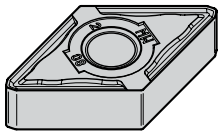

- Primär
- Sekundär

P	●
M	○
K	○
N	○
S	○
H	○

Kenloc™ • DNMG-Wendeschneidplatte • Negativ • MW

ISO	ANSI	D		L10		Rε		KCP25C
Katalognummer	Katalognummer	mm	Zoll	mm	Zoll	mm	Zoll	
DNMG150408MW	DNMG432MW	12.70	0.500	15.50	0.610	0.8	0.031	●
DNMG150608MW	DNMG442MW	12.70	0.500	15.50	0.610	0.8	0.031	●
DNMG150612MW	DNMG443MW	12.70	0.500	15.50	0.610	1.2	0.047	●

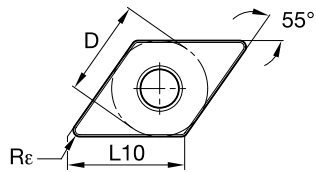

- Primär
- Sekundär

P	●
M	○
K	○
N	○
S	○
H	○

Kenloc™ • DNMG-Wendeschneidplatte • Negativ • RN

ISO	ANSI	D		L10		Rε		KCP25C
Katalognummer	Katalognummer	mm	Zoll	mm	Zoll	mm	Zoll	
DNMG150408RN	DNMG432RN	12.70	0.500	15.50	0.610	0.8	0.031	●
DNMG150412RN	DNMG433RN	12.70	0.500	15.50	0.610	1.2	0.047	●
DNMG150416RN	DNMG434RN	12.70	0.500	15.50	0.610	1.6	0.063	●
DNMG150608RN	DNMG442RN	12.70	0.500	15.50	0.610	0.8	0.031	●
DNMG150612RN	DNMG443RN	12.70	0.500	15.50	0.610	1.2	0.047	●
DNMG150616RN	DNMG444RN	12.70	0.500	15.50	0.610	1.6	0.063	●
DNMG190608RN	DNMG542RN	15.88	0.625	19.38	0.763	0.8	0.031	●
DNMG190612RN	DNMG543RN	15.88	0.625	19.38	0.763	1.2	0.047	●

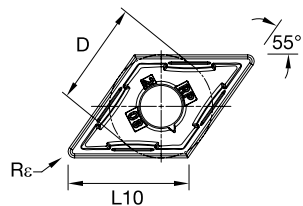

- Primär
- Sekundär

P	●
M	○
K	○
N	○
S	○
H	○

Kenloc™ • DNMG-Wendeschneidplatte • Negativ • RP

ISO	ANSI	D		L10		Rε		KCP25C
Katalognummer	Katalognummer	mm	Zoll	mm	Zoll	mm	Zoll	
DNMG110408RP	DNMG332RP	9.53	0.375	11.63	0.458	0.8	0.031	●
DNMG110412RP	DNMG333RP	9.53	0.375	11.63	0.458	1.2	0.047	●
DNMG150408RP	DNMG432RP	12.70	0.500	15.50	0.610	0.8	0.031	●
DNMG150412RP	DNMG433RP	12.70	0.500	15.50	0.610	1.2	0.047	●
DNMG150608RP	DNMG442RP	12.70	0.500	15.50	0.610	0.8	0.031	●
DNMG150612RP	DNMG443RP	12.70	0.500	15.50	0.610	1.2	0.047	●
DNMG150616RP	DNMG444RP	12.70	0.500	15.50	0.610	1.6	0.063	●

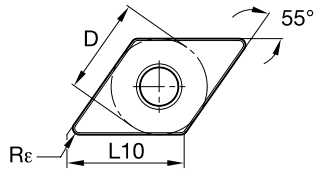
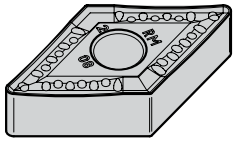

- Primär
- Sekundär

P	Blue	●
M	Yellow	○
K	Red	○
N	Green	○
S	Orange	○
H	Grey	○

Kenloc™ • DNMM-Wendeschneidplatte • Negativ • RM

ISO Katalognummer	ANSI Katalognummer	D		L10		Rε		● Primär ○ Sekundär
		mm	Zoll	mm	Zoll	mm	Zoll	
DNMM150408RM	DNMM432RM	12.70	0.500	15.50	0.610	0.8	0.031	●
DNMM150412RM	DNMM433RM	12.70	0.500	15.50	0.610	1.2	0.047	●
DNMM150608RM	DNMM442RM	12.70	0.500	15.50	0.610	0.8	0.031	●
DNMM150612RM	DNMM443RM	12.70	0.500	15.50	0.610	1.2	0.047	●
DNMM150616RM	DNMM444RM	12.70	0.500	15.50	0.610	1.6	0.063	●

KCP25C

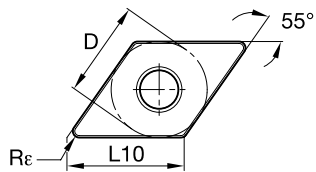
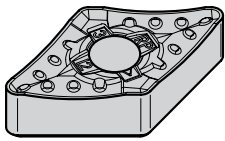

- Primär
- Sekundär

P	Blue	●
M	Yellow	○
K	Red	○
N	Green	○
S	Orange	○
H	Grey	○

Kenloc™ • DNMM-Wendeschneidplatte • Negativ • RP

ISO Katalognummer	ANSI Katalognummer	D		L10		Rε		● Primär ○ Sekundär
		mm	Zoll	mm	Zoll	mm	Zoll	
DNMM150608RP	DNMM442RP	12.70	0.500	15.50	0.610	0.8	0.031	●
DNMM150612RP	DNMM443RP	12.70	0.500	15.50	0.610	1.2	0.047	●
DNMM150616RP	DNMM444RP	12.70	0.500	15.50	0.610	1.6	0.063	●

KCP25C

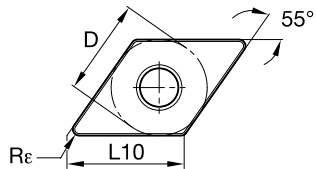
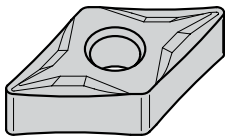

- Primär
- Sekundär

P	Blue	●
M	Yellow	○
K	Red	○
N	Green	○
S	Orange	○
H	Grey	○

Kenloc™ • DNMP-Wendeschneidplatte • Negativ • K

ISO Katalognummer	ANSI Katalognummer	D		L10		Rε		● Primär ○ Sekundär
		mm	Zoll	mm	Zoll	mm	Zoll	
DNMP110408K	DNMP332K	9.53	0.375	11.63	0.458	0.8	0.031	●
DNMP150404K	DNMP431K	12.70	0.500	15.14	0.596	0.4	0.016	●
DNMP150408K	DNMP432K	12.70	0.500	15.50	0.610	0.8	0.031	●
DNMP150604K	DNMP441K	12.70	0.500	15.50	0.610	0.4	0.016	●
DNMP150608K	DNMP442K	12.70	0.500	15.50	0.610	0.8	0.031	●

KCP25C

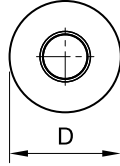
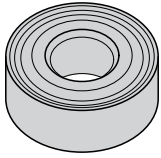

- Primär
- Sekundär

P	●
M	○
K	○
N	○
S	○
H	○

Kenloc™ • RNMG-Wendeschneidplatte • Negativ

ISO	ANSI	D		L10		Rε		KCP25C
Katalognummer	Katalognummer	mm	Zoll	mm	Zoll	mm	Zoll	
RNMG120400	RNMG43	12.70	0.500	-	-	-	-	●
RNMG190600	RNMG64	19.05	0.750	-	-	-	-	●

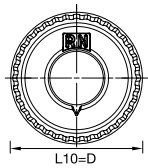

- Primär
- Sekundär

P	●
M	○
K	○
N	○
S	○
H	○

Kenloc™ • RNMG-Wendeschneidplatte • Negativ • RN

ISO	ANSI	D		L10		Rε		KCP25C
Katalognummer	Katalognummer	mm	Zoll	mm	Zoll	mm	Zoll	
RNMG090300RN	RNMG32RN	9.53	0.375	-	-	-	-	●
RNMG120400RN	RNMG43RN	12.70	0.500	-	-	-	-	●
RNMG190600RN	RNMG64RN	19.05	0.750	-	-	-	-	●

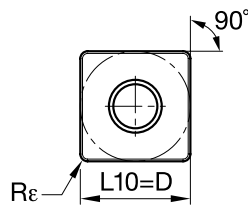
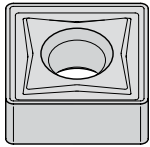

- Primär
- Sekundär

P	●
M	○
K	○
N	○
S	○
H	○

Kenloc™ • SNMG-Wendeschneidplatte • Negativ

ISO	ANSI	D		L10		Rε		KCP25C
Katalognummer	Katalognummer	mm	Zoll	mm	Zoll	mm	Zoll	
SNMG250924RN	SNMG866RN	25.40	1.000	25.40	1.000	2.4	0.094	●

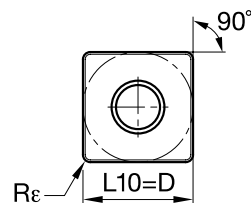
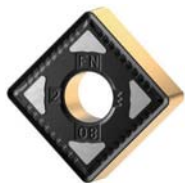

- Primär
- Sekundär

P	●
M	○
K	○
N	○
S	○
H	○

Kenloc™ • SNMG-Wendeschneidplatte • Negativ • FN

ISO	ANSI	D		L10		R		KCP25C
Katalognummer	Katalognummer	mm	Zoll	mm	Zoll	mm	Zoll	
SNMG120404FN	SNMG431FN	12.70	0.500	12.70	0.500	0.4	0.016	●
SNMG120408FN	SNMG432FN	12.70	0.500	12.70	0.500	0.8	0.031	●
SNMG120412FN	SNMG433FN	12.70	0.500	12.70	0.500	1.2	0.047	●

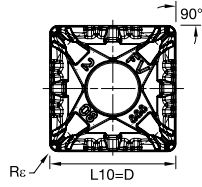
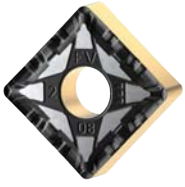

- Primär
- Sekundär

P	Blue	●
M	Yellow	○
K	Red	○
N	Green	○
S	Orange	○
H	Grey	○

Kenloc™ • SNMG-Wendeschneidplatte • Negativ • FV

ISO	ANSI	D		L10		Rε		KCP25C
Katalognummer	Katalognummer	mm	Zoll	mm	Zoll	mm	Zoll	
SNMG120408FV	SNMG432FV	12.70	0.500	12.70	0.500	0.8	0.031	●
SNMG120412FV	SNMG433FV	12.70	0.500	12.70	0.500	1.2	0.047	●

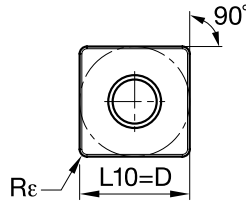
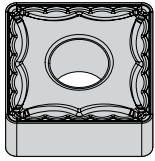

- Primär
- Sekundär

P	Blue	●
M	Yellow	○
K	Red	○
N	Green	○
S	Orange	○
H	Grey	○

Kenloc™ • SNMG-Wendeschneidplatte • Negativ • MG

ISO	ANSI	D		L10		Rε		KCP25C
Katalognummer	Katalognummer	mm	Zoll	mm	Zoll	mm	Zoll	
SNMG120416MG	SNMG434MG	12.70	0.500	12.70	0.500	1.6	0.063	●

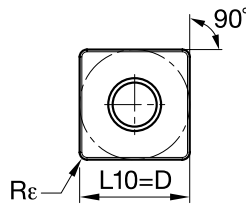
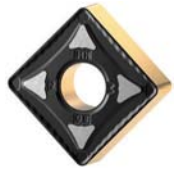

- Primär
- Sekundär

P	Blue	●
M	Yellow	○
K	Red	○
N	Green	○
S	Orange	○
H	Grey	○

Kenloc™ • SNMG-Wendeschneidplatte • Negativ • MN

ISO	ANSI	D		L10		Rε		KCP25C
Katalognummer	Katalognummer	mm	Zoll	mm	Zoll	mm	Zoll	
SNMG090308MN	SNMG322MN	9.53	0.375	9.53	0.375	0.8	0.031	●
SNMG120404MN	SNMG431MN	12.70	0.500	12.70	0.500	0.4	0.016	●
SNMG120408MN	SNMG432MN	12.70	0.500	12.70	0.500	0.8	0.031	●
SNMG120412MN	SNMG433MN	12.70	0.500	12.70	0.500	1.2	0.047	●
SNMG120416MN	SNMG434MN	12.70	0.500	12.70	0.500	1.6	0.063	●
SNMG150612MN	SNMG543MN	15.88	0.625	15.88	0.625	1.2	0.047	●
SNMG150616MN	SNMG544MN	15.88	0.625	15.88	0.625	1.6	0.063	●
SNMG190612MN	SNMG643MN	19.05	0.750	19.05	0.750	1.2	0.047	●

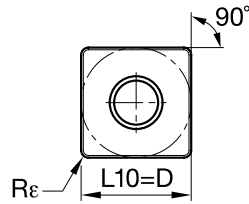
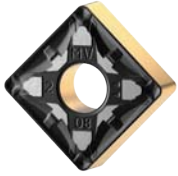

- Primär
- Sekundär

P	●
M	○
K	○
N	○
S	○
H	○

Kenloc™ • SNMG-Wendeschneidplatte • Negativ • MV

ISO Katalognummer	ANSI Katalognummer	D		L10		Rε		KCP25C
		mm	Zoll	mm	Zoll	mm	Zoll	
SNMG090308MV	SNMG322MV	9.53	0.375	9.53	0.375	0.8	0.031	●
SNMG120404MV	SNMG431MV	12.70	0.500	12.70	0.500	0.4	0.016	●
SNMG120408MV	SNMG432MV	12.70	0.500	12.70	0.500	0.8	0.031	●
SNMG120412MV	SNMG433MV	12.70	0.500	12.70	0.500	1.2	0.047	●
SNMG120416MV	SNMG434MV	12.70	0.500	12.70	0.500	1.6	0.063	●
SNMG150612MV	SNMG543MV	15.88	0.625	15.88	0.625	1.2	0.047	●
SNMG150616MV	SNMG544MV	15.88	0.625	15.88	0.625	1.6	0.063	●
SNMG190612MV	SNMG643MV	19.05	0.750	19.05	0.750	1.2	0.047	●
SNMG190616MV	SNMG644MV	19.05	0.750	19.05	0.750	1.6	0.063	●

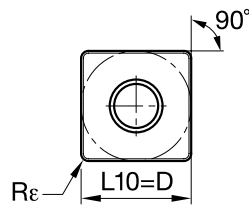

- Primär
- Sekundär

P	●
M	○
K	○
N	○
S	○
H	○

Kenloc™ • SNMG-Wendeschneidplatte • Negativ • RN

ISO Katalognummer	ANSI Katalognummer	D		L10		Rε		KCP25C
		mm	Zoll	mm	Zoll	mm	Zoll	
SNMG120408RN	SNMG432RN	12.70	0.500	12.70	0.500	0.8	0.031	●
SNMG120412RN	SNMG433RN	12.70	0.500	12.70	0.500	1.2	0.047	●
SNMG120416RN	SNMG434RN	12.70	0.500	12.70	0.500	1.6	0.063	●
SNMG150612RN	SNMG543RN	15.88	0.625	15.88	0.625	1.2	0.047	●
SNMG150616RN	SNMG544RN	15.88	0.625	15.88	0.625	1.6	0.063	●
SNMG190608RN	SNMG642RN	19.05	0.750	19.05	0.750	0.8	0.031	●
SNMG190612RN	SNMG643RN	19.05	0.750	19.05	0.750	1.2	0.047	●
SNMG190616RN	SNMG644RN	19.05	0.750	19.05	0.750	1.6	0.063	●

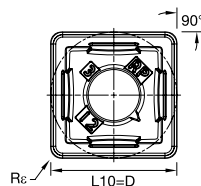
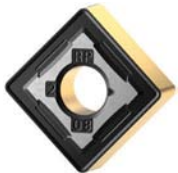

- Primär
- Sekundär

P	●
M	○
K	○
N	○
S	○
H	○

Kenloc™ • SNMG-Wendeschneidplatte • Negativ • RP

ISO Katalognummer	ANSI Katalognummer	D		L10		Rε		KCP25C
		mm	Zoll	mm	Zoll	mm	Zoll	
SNMG120408RP	SNMG432RP	12.70	0.500	12.70	0.500	0.8	0.031	●
SNMG120412RP	SNMG433RP	12.70	0.500	12.70	0.500	1.2	0.047	●
SNMG150612RP	SNMG543RP	15.88	0.625	15.88	0.625	1.2	0.047	●
SNMG150616RP	SNMG544RP	15.88	0.625	15.88	0.625	1.6	0.063	●
SNMG190612RP	SNMG643RP	19.05	0.750	19.05	0.750	1.2	0.047	●
SNMG190616RP	SNMG644RP	19.05	0.750	19.05	0.750	1.6	0.063	●

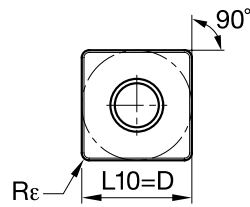
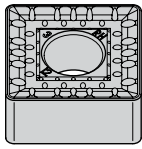

- Primär
- Sekundär

P	Blue	●
M	Yellow	○
K	Red	○
N	Green	○
S	Orange	○
H	Grey	○

Kenloc™ • SNMM-Wendeschneidplatte • Negativ • RH

ISO Katalognummer	ANSI Katalognummer	D		L10		Rε		● Primär ○ Sekundär
		mm	Zoll	mm	Zoll	mm	Zoll	
SNMM190612RH	SNMM643RH	19.05	0.750	19.05	0.750	1.2	0.047	●
SNMM190616RH	SNMM644RH	19.05	0.750	19.05	0.750	1.6	0.063	●
SNMM190624RH	SNMM646RH	19.05	0.750	19.05	0.750	2.4	0.094	●
SNMM250724RH	SNMM856RH	25.40	1.000	25.40	1.000	2.4	0.094	●
SNMM250732RH	SNMM858RH	25.40	1.000	25.40	1.000	3.2	0.125	●
SNMM250924RH	SNMM866RH	25.40	1.000	25.40	1.000	2.4	0.094	●

KCP25C

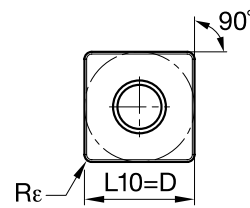
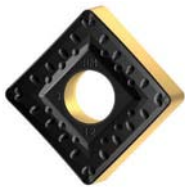

- Primär
- Sekundär

P	Blue	●
M	Yellow	○
K	Red	○
N	Green	○
S	Orange	○
H	Grey	○

Kenloc™ • SNMM-Wendeschneidplatte • Negativ • RM

ISO Katalognummer	ANSI Katalognummer	D		L10		Rε		● Primär ○ Sekundär
		mm	Zoll	mm	Zoll	mm	Zoll	
SNMM120408RM	SNMM432RM	12.70	0.500	12.70	0.500	0.8	0.031	●
SNMM120412RM	SNMM433RM	12.70	0.500	12.70	0.500	1.2	0.047	●
SNMM150612RM	SNMM543RM	15.88	0.625	15.88	0.625	1.2	0.047	●
SNMM150616RM	SNMM544RM	15.88	0.625	15.88	0.625	1.6	0.063	●
SNMM190612RM	SNMM643RM	19.05	0.750	19.05	0.750	1.2	0.047	●
SNMM190616RM	SNMM644RM	19.05	0.750	19.05	0.750	1.6	0.063	●
SNMM190624RM	SNMM646RM	19.05	0.750	19.05	0.750	2.4	0.094	●
SNMM250724RM	SNMM856RM	25.40	1.000	25.40	1.000	2.4	0.094	●
SNMM250924RM	SNMM866RM	25.40	1.000	25.40	1.000	2.4	0.094	●

KCP25C

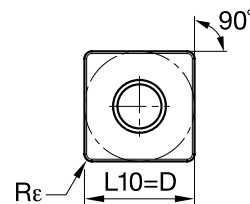
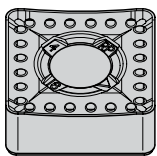

- Primär
- Sekundär

P	Blue	●
M	Yellow	○
K	Red	○
N	Green	○
S	Orange	○
H	Grey	○

Kenloc™ • SNMM-Wendeschneidplatte • Negativ • RP

ISO Katalognummer	ANSI Katalognummer	D		L10		Rε		● Primär ○ Sekundär
		mm	Zoll	mm	Zoll	mm	Zoll	
SNMM120408RP	SNMM432RP	12.70	0.500	12.70	0.500	0.8	0.031	●
SNMM120412RP	SNMM433RP	12.70	0.500	12.70	0.500	1.2	0.047	●
SNMM190624RP	SNMM646RP	19.05	0.750	19.05	0.750	2.4	0.094	●
SNMM250724RP	SNMM856RP	25.40	1.000	25.40	1.000	2.4	0.094	●
SNMM250924RP	SNMM866RP	25.40	1.000	25.40	1.000	2.4	0.094	●

KCP25C

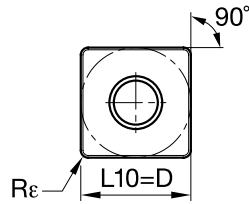

- Primär
- Sekundär

P	Blue	●
M	Yellow	●
K	Red	○
N	Green	●
S	Orange	●
H	Grey	●

Kenloc™ • SNMM-Wendeschneidplatte • Negativ • RW

ISO	ANSI	D		L10		Rε		KCP25C
Katalognummer	Katalognummer	mm	Zoll	mm	Zoll	mm	Zoll	
SNMM190624RW	SNMM646RW	19.05	0.750	19.05	0.750	2.4	0.094	●
SNMM250724RW	SNMM856RW	25.40	1.000	25.40	1.000	2.4	0.094	●

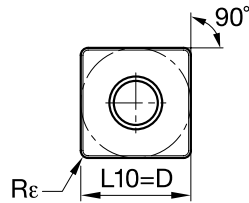
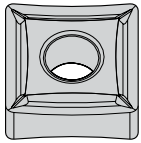

- Primär
- Sekundär

P	Blue	●
M	Yellow	●
K	Red	○
N	Green	●
S	Orange	●
H	Grey	●

Kenloc™ • SNMP-Wendeschneidplatte • Negativ • K

ISO	ANSI	D		L10		Rε		KCP25C
Katalognummer	Katalognummer	mm	Zoll	mm	Zoll	mm	Zoll	
SNMP120408K	SNMP432K	12.70	0.500	12.70	0.500	0.8	0.031	●

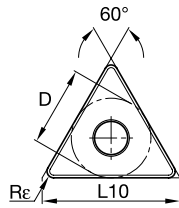

- Primär
- Sekundär

P	Blue	●
M	Yellow	●
K	Red	○
N	Green	●
S	Orange	●
H	Grey	●

Kenloc™ • TNMG-Wendeschneidplatte • Negativ • FN

ISO	ANSI	D		L10		R		KCP25C
Katalognummer	Katalognummer	mm	Zoll	mm	Zoll	mm	Zoll	
TNMG110304FN	TNMG221FN	6.35	0.250	11.00	0.433	0.4	0.016	●
TNMG160404FN	TNMG331FN	9.53	0.375	16.50	0.650	0.4	0.016	●
TNMG160408FN	TNMG332FN	9.53	0.375	16.50	0.650	0.8	0.031	●
TNMG160412FN	TNMG333FN	9.53	0.375	16.50	0.650	1.2	0.047	●
TNMG220404FN	TNMG431FN	12.70	0.500	22.00	0.866	0.4	0.016	●
TNMG220408FN	TNMG432FN	12.70	0.500	22.00	0.866	0.8	0.031	●

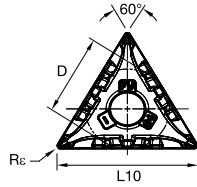
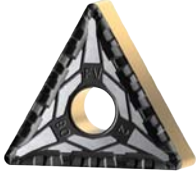

- Primär
- Sekundär

P	Blue	●
M	Yellow	○
K	Red	○
N	Green	○
S	Orange	○
H	Grey	○

Kenloc™ • TNMG-Wendeschnidplatte • Negativ • FV

ISO Katalognummer	ANSI Katalognummer	D		L10		R		● Primär ○ Sekundär
		mm	Zoll	mm	Zoll	mm	Zoll	
TNMG160404FV	TNMG331FV	9.53	0.375	16.50	0.650	0.4	0.016	●
TNMG160408FV	TNMG332FV	9.53	0.375	16.50	0.650	0.8	0.031	●
TNMG160412FV	TNMG333FV	9.53	0.375	16.50	0.650	1.2	0.047	●
TNMG220404FV	TNMG431FV	12.70	0.500	22.00	0.866	0.4	0.016	●
TNMG220408FV	TNMG432FV	12.70	0.500	22.00	0.866	0.8	0.031	●

KCP25C

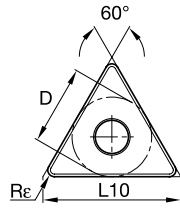

- Primär
- Sekundär

P	Blue	●
M	Yellow	○
K	Red	○
N	Green	○
S	Orange	○
H	Grey	○

Kenloc™ • TNMG-Wendeschnidplatte • Negativ • MN

ISO Katalognummer	ANSI Katalognummer	D		L10		Rc		● Primär ○ Sekundär
		mm	Zoll	mm	Zoll	mm	Zoll	
TNMG160404MN	TNMG331MN	9.53	0.375	16.50	0.650	0.4	0.016	●
TNMG160408MN	TNMG332MN	9.53	0.375	16.50	0.650	0.8	0.031	●
TNMG160412MN	TNMG333MN	9.53	0.375	16.50	0.650	1.2	0.047	●
TNMG220404MN	TNMG431MN	12.70	0.500	22.00	0.866	0.4	0.016	●
TNMG220408MN	TNMG432MN	12.70	0.500	22.00	0.866	0.8	0.031	●
TNMG220412MN	TNMG433MN	12.70	0.500	22.00	0.866	1.2	0.047	●

KCP25C

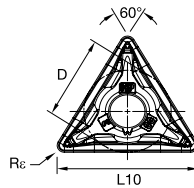
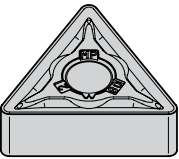

- Primär
- Sekundär

P	Blue	●
M	Yellow	○
K	Red	○
N	Green	○
S	Orange	○
H	Grey	○

Kenloc™ • TNMG-Wendeschnidplatte • Negativ • MP

ISO Katalognummer	ANSI Katalognummer	D		L10		Rc		● Primär ○ Sekundär
		mm	Zoll	mm	Zoll	mm	Zoll	
TNMG160408MP	TNMG332MP	9.53	0.375	16.50	0.650	0.8	0.031	●

KCP25C

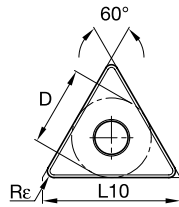
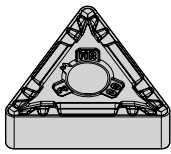

- Primär
- Sekundär

P	Blue	●
M	Yellow	○
K	Red	○
N	Green	○
S	Orange	○
H	Grey	○

Kenloc™ • TNMG-Wendeschneidplatte • Negativ • MR

ISO Katalognummer	ANSI Katalognummer	D		L10		Rε		● Primär ○ Sekundär
		mm	Zoll	mm	Zoll	mm	Zoll	
TNMG160408MR	TNMG332MR	9.53	0.375	16.50	0.650	0.8	0.031	●
TNMG160412MR	TNMG333MR	9.53	0.375	16.50	0.650	1.2	0.047	●
TNMG220408MR	TNMG432MR	12.70	0.500	22.00	0.866	0.8	0.031	●

KCP25C

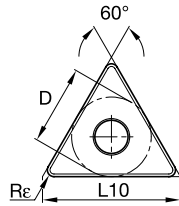
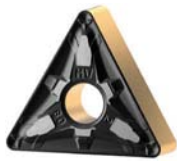

- Primär
- Sekundär

P	Blue	●
M	Yellow	○
K	Red	○
N	Green	○
S	Orange	○
H	Grey	○

Kenloc™ • TNMG-Wendeschneidplatte • Negativ • MV

ISO Katalognummer	ANSI Katalognummer	D		L10		Rε		● Primär ○ Sekundär
		mm	Zoll	mm	Zoll	mm	Zoll	
TNMG160404MV	TNMG331MV	9.53	0.375	16.50	0.650	0.4	0.016	●
TNMG160408MV	TNMG332MV	9.53	0.375	16.50	0.650	0.8	0.031	●
TNMG160412MV	TNMG333MV	9.53	0.375	16.50	0.650	1.2	0.047	●
TNMG220404MV	TNMG431MV	12.70	0.500	22.00	0.866	0.4	0.016	●
TNMG220408MV	TNMG432MV	12.70	0.500	22.00	0.866	0.8	0.031	●
TNMG220412MV	TNMG433MV	12.70	0.500	22.00	0.866	1.2	0.047	●

KCP25C

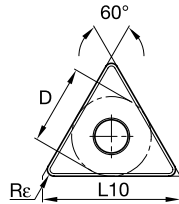
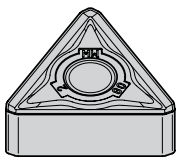

- Primär
- Sekundär

P	Blue	●
M	Yellow	○
K	Red	○
N	Green	○
S	Orange	○
H	Grey	○

Kenloc™ • TNMG-Wendeschneidplatte • Negativ • MW

ISO Katalognummer	ANSI Katalognummer	D		L10		Rε		● Primär ○ Sekundär
		mm	Zoll	mm	Zoll	mm	Zoll	
TNMG160408MW	TNMG332MW	9.53	0.375	16.50	0.650	0.8	0.031	●
TNMG160412MW	TNMG333MW	9.53	0.375	16.50	0.650	1.2	0.047	●

KCP25C

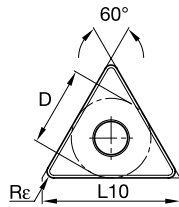

- Primär
- Sekundär

P	Blue	●
M	Yellow	○
K	Red	○
N	Green	○
S	Orange	○
H	Grey	○

Kenloc™ • TNMG-Wendeschneidplatte • Negativ • RN

ISO Katalognummer	ANSI Katalognummer	D		L10		Rε		● Primär ○ Sekundär
		mm	Zoll	mm	Zoll	mm	Zoll	
TNMG160408RN	TNMG332RN	9.53	0.375	16.50	0.650	0.8	0.031	●
TNMG160412RN	TNMG333RN	9.53	0.375	16.50	0.650	1.2	0.047	●
TNMG220408RN	TNMG432RN	12.70	0.500	22.00	0.866	0.8	0.031	●
TNMG220412RN	TNMG433RN	12.70	0.500	22.00	0.866	1.2	0.047	●
TNMG220416RN	TNMG434RN	12.70	0.500	22.00	0.866	1.6	0.063	●
TNMG270612RN	TNMG543RN	15.88	0.625	27.50	1.083	1.2	0.047	●
TNMG330924RN	TNMG666RN	19.05	0.750	33.00	1.299	2.4	0.094	●

KCP25C

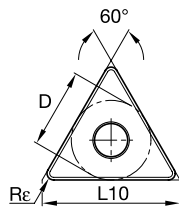

- Primär
- Sekundär

P	Blue	●
M	Yellow	○
K	Red	○
N	Green	○
S	Orange	○
H	Grey	○

Kenloc™ • TNMG-Wendeschneidplatte • Negativ • RP

ISO Katalognummer	ANSI Katalognummer	D		L10		Rε		● Primär ○ Sekundär
		mm	Zoll	mm	Zoll	mm	Zoll	
TNMG160408RP	TNMG332RP	9.53	0.375	16.50	0.650	0.8	0.031	●
TNMG160412RP	TNMG333RP	9.53	0.375	16.50	0.650	1.2	0.047	●
TNMG220408RP	TNMG432RP	12.70	0.500	22.00	0.866	0.8	0.031	●
TNMG220412RP	TNMG433RP	12.70	0.500	22.00	0.866	1.2	0.047	●
TNMG220416RP	TNMG434RP	12.70	0.500	22.00	0.866	1.6	0.063	●
TNMG220432RP	TNMG438RP	12.70	0.500	22.00	0.866	3.2	0.125	●
TNMG270612RP	TNMG543RP	15.88	0.625	27.50	1.083	1.2	0.047	●

KCP25C

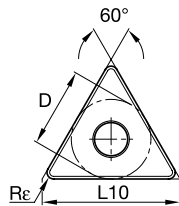
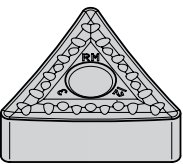

- Primär
- Sekundär

P	Blue	●
M	Yellow	○
K	Red	○
N	Green	○
S	Orange	○
H	Grey	○

Kenloc™ • TNMM-Wendeschneidplatte • Negativ • RM

ISO Katalognummer	ANSI Katalognummer	D		L10		Rε		● Primär ○ Sekundär
		mm	Zoll	mm	Zoll	mm	Zoll	
TNMM160408RM	TNMM332RM	9.53	0.375	16.50	0.650	0.8	0.031	●
TNMM160412RM	TNMM333RM	9.53	0.375	16.50	0.650	1.2	0.047	●
TNMM220408RM	TNMM432RM	12.70	0.500	22.00	0.866	0.8	0.031	●
TNMM220412RM	TNMM433RM	12.70	0.500	22.00	0.866	1.2	0.047	●
TNMM220416RM	TNMM434RM	12.70	0.500	22.00	0.866	1.6	0.063	●
TNMM270612RM	TNMM543RM	15.88	0.625	27.50	1.083	1.2	0.047	●
TNMM270616RM	TNMM544RM	15.88	0.625	27.50	1.083	1.6	0.063	●

KCP25C

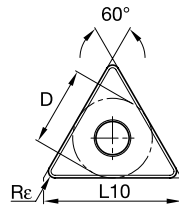

- Primär
- Sekundär

P	●
M	○
K	○
N	○
S	○
H	○

Kenloc™ • TNMM-Wendescheidplatte • Negativ • RP

ISO	ANSI	D		L10		R		KCP25C
Katalognummer	Katalognummer	mm	Zoll	mm	Zoll	mm	Zoll	
TNMM220412RP	TNMM433RP	12.70	0.500	22.00	0.866	1.2	0.047	●

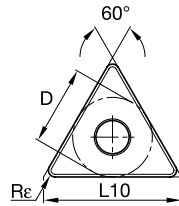
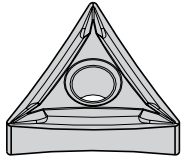

- Primär
- Sekundär

P	●
M	○
K	○
N	○
S	○
H	○

Kenloc™ • TNMP-Wendescheidplatte • Negativ • K

ISO	ANSI	D		L10		Rε		KCP25C
Katalognummer	Katalognummer	mm	Zoll	mm	Zoll	mm	Zoll	
TNMP160408K	TNMP332K	9.53	0.375	16.50	0.650	0.8	0.031	●
TNMP220408K	TNMP432K	12.70	0.500	22.00	0.866	0.8	0.031	●

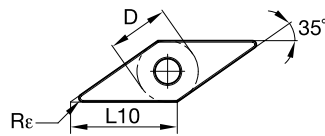

- Primär
- Sekundär

P	●
M	○
K	○
N	○
S	○
H	○

Kenloc™ • VNMG-Wendescheidplatte • Negativ • FN

ISO	ANSI	D		L10		Rε		KCP25C
Katalognummer	Katalognummer	mm	Zoll	mm	Zoll	mm	Zoll	
VNMG160404FN	VNMG331FN	9.53	0.375	16.61	0.654	0.4	0.016	●
VNMG160408FN	VNMG332FN	9.53	0.375	16.61	0.654	0.8	0.031	●

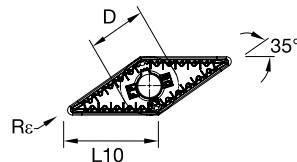
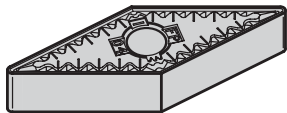

- Primär
- Sekundär

P	●
M	○
K	○
N	○
S	○
H	○

Kenloc™ • VNMG-Wendescheidplatte • Negativ • FP

ISO	ANSI	D		L10		Rε		KCP25C
Katalognummer	Katalognummer	mm	Zoll	mm	Zoll	mm	Zoll	
VNMG160408FP	VNMG332FP	9.53	0.375	16.61	0.654	0.8	0.031	●

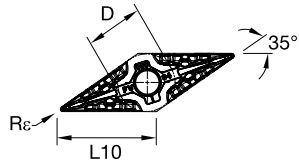

- Primär
- Sekundär

P	●
M	○
K	○
N	○
S	○
H	○

Kenloc™ • VNMG-Wendeschnidplatte • Negativ • FV

ISO	ANSI	D		L10		Rε		KCP25C
Katalognummer	Katalognummer	mm	Zoll	mm	Zoll	mm	Zoll	
VNMG160404FV	VNMG331FV	9.53	0.375	16.61	0.654	0.4	0.016	●
VNMG160408FV	VNMG332FV	9.53	0.375	16.61	0.654	0.8	0.031	●

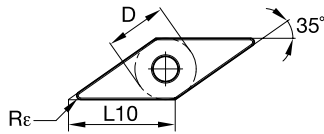

- Primär
- Sekundär

P	●
M	○
K	○
N	○
S	○
H	○

Kenloc™ • VNMG-Wendeschnidplatte • Negativ • MN

ISO	ANSI	D		L10		Rε		KCP25C
Katalognummer	Katalognummer	mm	Zoll	mm	Zoll	mm	Zoll	
VNMG160404MN	VNMG331MN	9.53	0.375	16.61	0.654	0.4	0.016	●
VNMG160408MN	VNMG332MN	9.53	0.375	16.61	0.654	0.8	0.031	●
VNMG160412MN	VNMG333MN	9.53	0.375	16.61	0.654	1.2	0.047	●

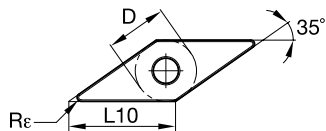

- Primär
- Sekundär

P	●
M	○
K	○
N	○
S	○
H	○

Kenloc™ • VNMG-Wendeschnidplatte • Negativ • MV

ISO	ANSI	D		L10		Rε		KCP25C
Katalognummer	Katalognummer	mm	Zoll	mm	Zoll	mm	Zoll	
VNMG160404MV	VNMG331MV	9.53	0.375	16.61	0.654	0.4	0.016	●
VNMG160408MV	VNMG332MV	9.53	0.375	16.61	0.654	0.8	0.031	●
VNMG160412MV	VNMG333MV	9.53	0.375	16.61	0.654	1.2	0.047	●

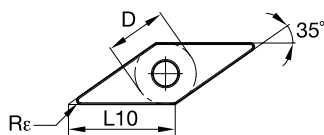
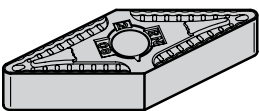

- Primär
- Sekundär

P	●
M	○
K	○
N	○
S	○
H	○

Kenloc™ • VNMG-Wendeschnidplatte • Negativ • RN

ISO	ANSI	D		L10		R		KCP25C
Katalognummer	Katalognummer	mm	Zoll	mm	Zoll	mm	Zoll	
VNMG160408RN	VNMG332RN	9.53	0.375	16.61	0.654	0.8	0.031	●
VNMG160412RN	VNMG333RN	9.53	0.375	16.61	0.654	1.2	0.047	●
VNMG220408RN	VNMG432RN	12.70	0.500	22.14	0.872	0.8	0.031	●
VNMG220412RN	VNMG433RN	12.70	0.500	22.14	0.872	1.2	0.047	●

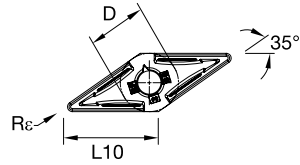

- Primär
- Sekundär

P	●
M	○
K	○
N	○
S	○
H	○

Kenloc™ • VNMG-Wendeschneidplatte • Negativ • RP

ISO	ANSI	D		L10		Rε		KCP25C
Katalognummer	Katalognummer	mm	Zoll	mm	Zoll	mm	Zoll	
VNMG160408RP	VNMG332RP	9.53	0.375	16.61	0.654	0.8	0.031	●
VNMG160412RP	VNMG333RP	9.53	0.375	16.61	0.654	1.2	0.047	●

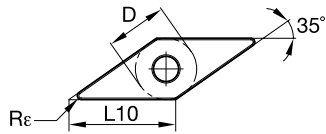
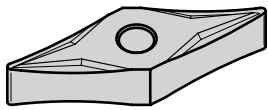

- Primär
- Sekundär

P	●
M	○
K	○
N	○
S	○
H	○

Kenloc™ • VNMP-Wendeschneidplatte • Negativ • K

ISO	ANSI	D		L10		R		KCP25C
Katalognummer	Katalognummer	mm	Zoll	mm	Zoll	mm	Zoll	
VNMP160404K	VNMP331K	9.53	0.375	16.61	0.654	0.4	0.016	●
VNMP160408K	VNMP332K	9.53	0.375	16.61	0.654	0.8	0.031	●

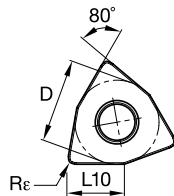
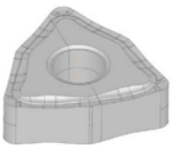

- Primär
- Sekundär

P	●
M	○
K	○
N	○
S	○
H	○

Kenloc™ • WNMG-Wendeschneidplatte • Negativ • FM

ISO	ANSI	D		L10		R		KCP25C
Katalognummer	Katalognummer	mm	Zoll	mm	Zoll	mm	Zoll	
WNMG080412FM	WNMG433FM	12.70	0.500	8.69	0.342	1.2	0.047	●

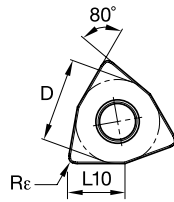
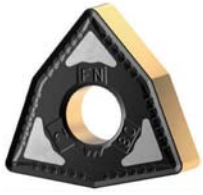

- Primär
- Sekundär

P	Blue	●
M	Yellow	●
K	Red	○
N	Green	●
S	Orange	●
H	Grey	●

Kenloc™ • WNMG-Wendeschneidplatte • Negativ • FN

ISO Katalognummer	ANSI Katalognummer	D		L10		Rε		● Primär ○ Sekundär
		mm	Zoll	mm	Zoll	mm	Zoll	
WNMG060408FN	WNMG332FN	9.53	0.375	6.52	0.257	0.8	0.031	●
WNMG080404FN	WNMG431FN	12.70	0.500	8.69	0.342	0.4	0.016	●
WNMG080408FN	WNMG432FN	12.70	0.500	8.69	0.342	0.8	0.031	●

KCP25C

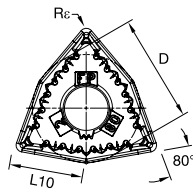
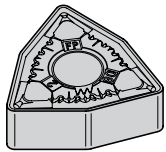

- Primär
- Sekundär

P	Blue	●
M	Yellow	●
K	Red	○
N	Green	●
S	Orange	●
H	Grey	●

Kenloc™ • WNMG-Wendeschneidplatte • Negativ • FP

ISO Katalognummer	ANSI Katalognummer	D		L10		Rε		● Primär ○ Sekundär
		mm	Zoll	mm	Zoll	mm	Zoll	
WNMG080404FP	WNMG431FP	12.70	0.500	8.69	0.342	0.4	0.016	●
WNMG080408FP	WNMG432FP	12.70	0.500	8.69	0.342	0.8	0.031	●

KCP25C

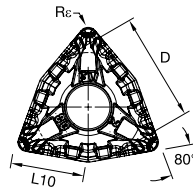
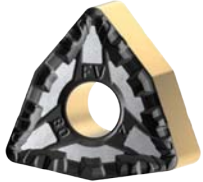

- Primär
- Sekundär

P	Blue	●
M	Yellow	●
K	Red	○
N	Green	●
S	Orange	●
H	Grey	●

Kenloc™ • WNMG-Wendeschneidplatte • Negativ • FV

ISO Katalognummer	ANSI Katalognummer	D		L10		R		● Primär ○ Sekundär
		mm	Zoll	mm	Zoll	mm	Zoll	
WNMG060408FV	WNMG332FV	9.53	0.375	6.52	0.257	0.8	0.031	●
WNMG080404FV	WNMG431FV	12.70	0.500	8.69	0.342	0.4	0.016	●
WNMG080408FV	WNMG432FV	12.70	0.500	8.69	0.342	0.8	0.031	●

KCP25C

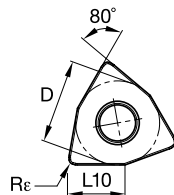
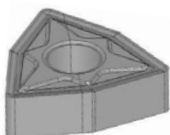

- Primär
- Sekundär

P	Blue	●
M	Yellow	●
K	Red	○
N	Green	●
S	Orange	●
H	Grey	●

Kenloc™ • WNMG-Wendeschneidplatte • Negativ • MG

ISO Katalognummer	ANSI Katalognummer	D		L10		R		● Primär ○ Sekundär
		mm	Zoll	mm	Zoll	mm	Zoll	
WNMG080408MG	WNMG432MG	12.70	0.500	8.69	0.342	0.8	0.031	●

KCP25C

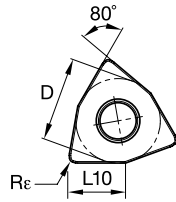
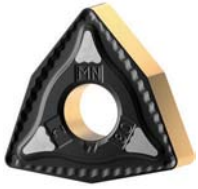

- Primär
- Sekundär

P	Blue	●
M	Yellow	○
K	Red	○
N	Green	○
S	Orange	○
H	Grey	○

Kenloc™ • WNMG-Wendeschneidplatte • Negativ • MN

ISO Katalognummer	ANSI Katalognummer	D		L10		R		KCP25C
		mm	Zoll	mm	Zoll	mm	Zoll	
WNMG060404MN	WNMG331MN	9.53	0.375	6.52	0.257	0.4	0.016	●
WNMG060408MN	WNMG332MN	9.53	0.375	6.52	0.257	0.8	0.031	●
WNMG080408MN	WNMG432MN	12.70	0.500	8.69	0.342	0.8	0.031	●
WNMG080412MN	WNMG433MN	12.70	0.500	8.69	0.342	1.2	0.047	●
WNMG080416MN	WNMG434MN	12.70	0.500	8.69	0.342	1.6	0.063	●

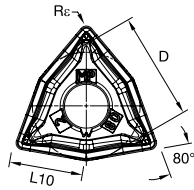
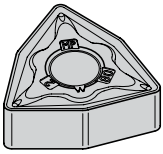

- Primär
- Sekundär

P	Blue	●
M	Yellow	○
K	Red	○
N	Green	○
S	Orange	○
H	Grey	○

Kenloc™ • WNMG-Wendeschneidplatte • Negativ • MP

ISO Katalognummer	ANSI Katalognummer	D		L10		Re		KCP25C
		mm	Zoll	mm	Zoll	mm	Zoll	
WNMG080408MP	WNMG432MP	12.70	0.500	8.69	0.342	0.8	0.031	●
WNMG080412MP	WNMG433MP	12.70	0.500	8.69	0.342	1.2	0.047	●

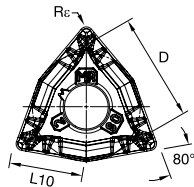
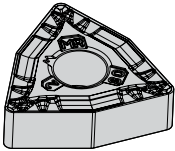

- Primär
- Sekundär

P	Blue	●
M	Yellow	○
K	Red	○
N	Green	○
S	Orange	○
H	Grey	○

Kenloc™ • WNMG-Wendeschneidplatte • Negativ • MR

ISO Katalognummer	ANSI Katalognummer	D		L10		Re		KCP25C
		mm	Zoll	mm	Zoll	mm	Zoll	
WNMG080408MR	WNMG432MR	12.70	0.500	8.69	0.342	0.8	0.031	●
WNMG080412MR	WNMG433MR	12.70	0.500	8.69	0.342	1.2	0.047	●

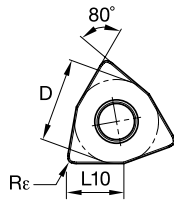
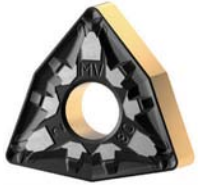

- Primär
- Sekundär

P	Blue	●
M	Yellow	○
K	Red	○
N	Green	○
S	Orange	○
H	Grey	○

Kenloc™ • WNMG-Wendeschneidplatte • Negativ • MV

ISO Katalognummer	ANSI Katalognummer	D		L10		Rε		● Primär ○ Sekundär
		mm	Zoll	mm	Zoll	mm	Zoll	
WNMG060408MV	WNMG332MV	9.52	0.375	6.52	0.257	0.8	0.031	●
WNMG060412MV	WNMG333MV	9.53	0.375	6.52	0.257	1.2	0.047	●
WNMG080408MV	WNMG432MV	12.70	0.500	8.69	0.342	0.8	0.031	●
WNMG080412MV	WNMG433MV	12.70	0.500	8.69	0.342	1.2	0.047	●
WNMG080416MV	WNMG434MV	12.70	0.500	8.69	0.342	1.6	0.063	●

KCP25C

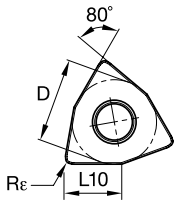
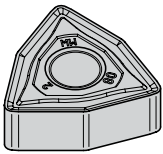

- Primär
- Sekundär

P	Blue	●
M	Yellow	○
K	Red	○
N	Green	○
S	Orange	○
H	Grey	○

Kenloc™ • WNMG-Wendeschneidplatte • Negativ • MW

ISO Katalognummer	ANSI Katalognummer	D		L10		Rε		● Primär ○ Sekundär
		mm	Zoll	mm	Zoll	mm	Zoll	
WNMG080408MW	WNMG432MW	12.70	0.500	8.69	0.342	0.8	0.031	●
WNMG080412MW	WNMG433MW	12.70	0.500	8.69	0.342	1.2	0.047	●

KCP25C

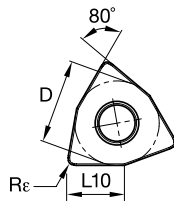

- Primär
- Sekundär

P	Blue	●
M	Yellow	○
K	Red	○
N	Green	○
S	Orange	○
H	Grey	○

Kenloc™ • WNMG-Wendeschneidplatte • Negativ • RN

ISO Katalognummer	ANSI Katalognummer	D		L10		Rε		● Primär ○ Sekundär
		mm	Zoll	mm	Zoll	mm	Zoll	
WNMG060408RN	WNMG332RN	9.53	0.375	6.52	0.257	0.8	0.031	●
WNMG060412RN	WNMG333RN	9.53	0.375	6.52	0.257	1.2	0.047	●
WNMG080408RN	WNMG432RN	12.70	0.500	8.69	0.342	0.8	0.031	●
WNMG080412RN	WNMG433RN	12.70	0.500	8.69	0.342	1.2	0.047	●
WNMG080416RN	WNMG434RN	12.70	0.500	8.69	0.342	1.6	0.063	●

KCP25C

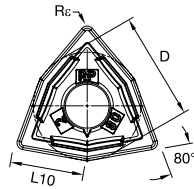
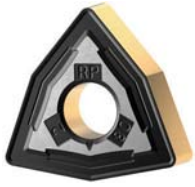

- Primär
- Sekundär

P	Blue	●
M	Yellow	○
K	Red	○
N	Green	○
S	Orange	○
H	Grey	○

Kenloc™ • WNMG-Wendeschnidplatte • Negativ • RP

ISO Katalognummer	ANSI Katalognummer	D		L10		Rε		● Primär ○ Sekundär
		mm	Zoll	mm	Zoll	mm	Zoll	
WNMG060408RP	WNMG332RP	9.53	0.375	6.52	0.257	0.8	0.031	●
WNMG060412RP	WNMG333RP	9.53	0.375	6.52	0.257	1.2	0.047	●
WNMG080408RP	WNMG432RP	12.70	0.500	8.69	0.342	0.8	0.031	●
WNMG080412RP	WNMG433RP	12.70	0.500	8.69	0.342	1.2	0.047	●
WNMG080416RP	WNMG434RP	12.70	0.500	8.69	0.342	1.6	0.063	●

KCP25C

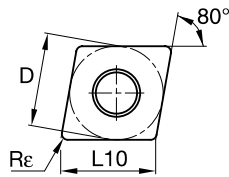
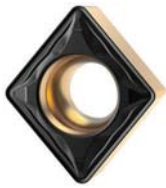

- Primär
- Sekundär

P	Blue	●
M	Yellow	○
K	Red	○
N	Green	○
S	Orange	○
H	Grey	○

Screw-On • CCMT-Wendeschnidplatte • Positiv • FP

ISO Katalognummer	ANSI Katalognummer	D		L10		Rε		● Primär ○ Sekundär
		mm	Zoll	mm	Zoll	mm	Zoll	
CCMT060202FP	CCMT21505FP	6.35	0.250	6.45	0.254	0.2	0.008	●
CCMT060204FP	CCMT2151FP	6.35	0.250	6.45	0.254	0.4	0.016	●
CCMT060208FP	CCMT2152FP	6.35	0.250	6.45	0.254	0.8	0.031	●
CCMT09T302FP	CCMT32505FP	9.53	0.375	9.67	0.381	0.2	0.008	●
CCMT09T304FP	CCMT3251FP	9.53	0.375	9.67	0.381	0.4	0.016	●
CCMT09T308FP	CCMT3252FP	9.53	0.375	9.67	0.381	0.8	0.031	●
CCMT120404FP	CCMT431FP	12.70	0.500	12.90	0.508	0.4	0.016	●
CCMT120408FP	CCMT432FP	12.70	0.500	12.90	0.508	0.8	0.031	●

KCP25C

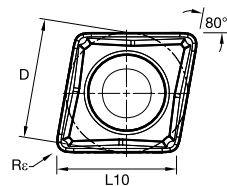
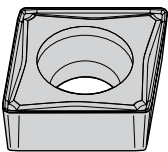

- Primär
- Sekundär

P	Blue	●
M	Yellow	○
K	Red	○
N	Green	○
S	Orange	○
H	Grey	○

Screw-On • CCMT-Wendeschnidplatte • Positiv • FW

ISO Katalognummer	ANSI Katalognummer	D		L10		Rε		● Primär ○ Sekundär
		mm	Zoll	mm	Zoll	mm	Zoll	
CCMT060204FW	CCMT2151FW	6.35	0.250	6.45	0.254	0.4	0.016	●
CCMT09T304FW	CCMT3251FW	9.53	0.375	9.67	0.381	0.4	0.016	●

KCP25C

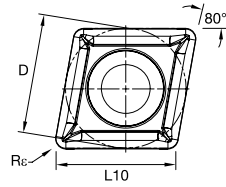
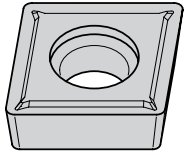

- Primär
- Sekundär

P	Blue	●
M	Yellow	○
K	Red	○
N	Green	○
S	Orange	○
H	Grey	○

Screw-On • CCMT-Wendeschnidplatte • Positiv • LF

ISO Katalognummer	ANSI Katalognummer	D		L10		Rε		● Primär ○ Sekundär
		mm	Zoll	mm	Zoll	mm	Zoll	
CCMT060202LF	CCMT21505LF	6.35	0.250	6.45	0.254	0.2	0.008	●
CCMT060204LF	CCMT2151LF	6.35	0.250	6.45	0.254	0.4	0.016	●
CCMT060208LF	CCMT2152LF	6.35	0.250	6.45	0.254	0.8	0.031	●
CCMT09T302LF	CCMT32505LF	9.53	0.375	9.67	0.381	0.2	0.008	●
CCMT09T304LF	CCMT3251LF	9.53	0.375	9.67	0.381	0.4	0.016	●
CCMT09T308LF	CCMT3252LF	9.53	0.375	9.67	0.381	0.8	0.031	●
CCMT120404LF	CCMT431LF	12.70	0.500	12.90	0.508	0.4	0.016	●
CCMT120408LF	CCMT432LF	12.70	0.500	12.90	0.508	0.8	0.031	●
CCMT120412LF	CCMT433LF	12.70	0.500	12.90	0.508	1.2	0.047	●

KCP25C

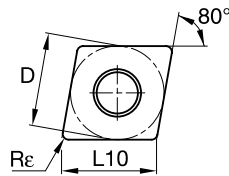
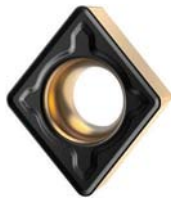

- Primär
- Sekundär

P	Blue	●
M	Yellow	○
K	Red	○
N	Green	○
S	Orange	○
H	Grey	○

Screw-On • CCMT-Wendeschnidplatte • Positiv • MF

ISO Katalognummer	ANSI Katalognummer	D		L10		Rε		● Primär ○ Sekundär
		mm	Zoll	mm	Zoll	mm	Zoll	
CCMT060204MF	CCMT2151MF	6.35	0.250	6.45	0.254	0.4	0.016	●
CCMT060208MF	CCMT2152MF	6.35	0.250	6.45	0.254	0.8	0.031	●
CCMT09T304MF	CCMT3251MF	9.53	0.375	9.67	0.381	0.4	0.016	●
CCMT09T308MF	CCMT3252MF	9.53	0.375	9.67	0.381	0.8	0.031	●
CCMT09T312MF	CCMT3253MF	9.53	0.375	9.67	0.381	1.2	0.047	●
CCMT120408MF	CCMT432MF	12.70	0.500	12.90	0.508	0.8	0.031	●
CCMT120412MF	CCMT433MF	12.70	0.500	12.90	0.508	1.2	0.047	●

KCP25C

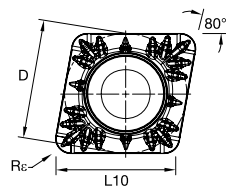
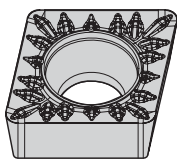

- Primär
- Sekundär

P	Blue	●
M	Yellow	○
K	Red	○
N	Green	○
S	Orange	○
H	Grey	○

Screw-On • CCMT-Wendeschnidplatte • Positiv • MP

ISO Katalognummer	ANSI Katalognummer	D		L10		Rε		● Primär ○ Sekundär
		mm	Zoll	mm	Zoll	mm	Zoll	
CCMT060204MP	CCMT2151MP	6.35	0.250	6.45	0.254	0.4	0.016	●
CCMT09T304MP	CCMT3251MP	9.53	0.375	9.53	0.375	0.4	0.016	●
CCMT09T308MP	CCMT3252MP	9.53	0.375	9.67	0.381	0.8	0.031	●
CCMT09T312MP	CCMT3253MP	9.53	0.375	9.67	0.381	1.2	0.047	●
CCMT120408MP	CCMT432MP	12.70	0.500	12.90	0.508	0.8	0.031	●

KCP25C

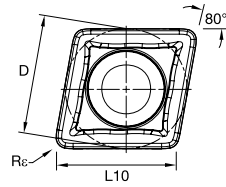
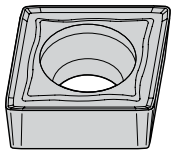

- Primär
- Sekundär

P	Blue	●
M	Yellow	●
K	Red	○
N	Green	●
S	Orange	●
H	Grey	●

Screw-On • CCMT-Wendeschneidplatte • Positiv • MW

ISO	ANSI	D		L10		Rε		KCP25C
Katalognummer	Katalognummer	mm	Zoll	mm	Zoll	mm	Zoll	
CCMT09T308MW	CCMT3252MW	9.53	0.375	9.67	0.381	0.8	0.031	●
CCMT120408MW	CCMT432MW	12.70	0.500	12.90	0.508	0.8	0.031	●

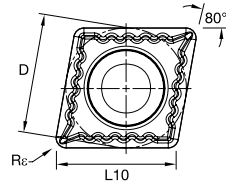
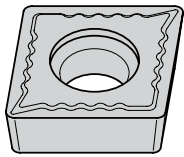

- Primär
- Sekundär

P	Blue	●
M	Yellow	●
K	Red	○
N	Green	●
S	Orange	●
H	Grey	●

Screw-On • CCMT-Wendeschneidplatte • Positiv • UF

ISO	ANSI	D		L10		Rε		KCP25C
Katalognummer	Katalognummer	mm	Zoll	mm	Zoll	mm	Zoll	
CCMT060204UF	CCMT2151UF	6.35	0.250	6.45	0.254	0.4	0.016	●
CCMT09T304UF	CCMT3251UF	9.53	0.375	9.67	0.381	0.4	0.016	●

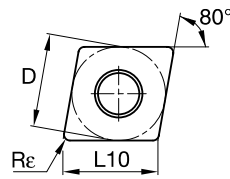
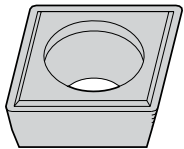

- Primär
- Sekundär

P	Blue	●
M	Yellow	●
K	Red	○
N	Green	●
S	Orange	●
H	Grey	●

Screw-On • CPGM-Wendeschneidplatte • Positiv

ISO	ANSI	D		L10		Rε		KCP25C
Katalognummer	Katalognummer	mm	Zoll	mm	Zoll	mm	Zoll	
CPGH09T302	CPGM32505	9.53	0.375	9.67	0.381	0.2	0.008	●
CPGH09T304	CPGM3251	9.53	0.375	9.67	0.381	0.4	0.016	●
CPGH09T308	CPGM3252	9.53	0.375	9.67	0.381	0.8	0.031	●
CPGT060202K	CPGM21505	6.35	0.250	6.45	0.254	0.2	0.008	●
CPGT060204K	CPGM2151	6.35	0.250	6.45	0.254	0.4	0.016	●
CPGT060208K	CPGM2152	6.35	0.250	6.45	0.254	0.8	0.031	●

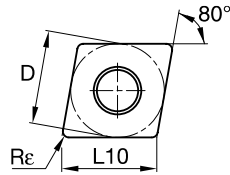
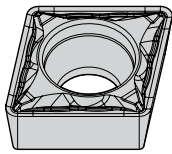

- Primär
- Sekundär

P	Blue	●
M	Yellow	○
K	Red	○
N	Green	○
S	Orange	○
H	Grey	○

Screw-On • CPMT-Wendeschneidplatte • Positiv • FP

ISO Katalognummer	ANSI Katalognummer	D		L10		Rε		● Primär ○ Sekundär
		mm	Zoll	mm	Zoll	mm	Zoll	
CPMT050204FP	CPMT18151FP	5.56	0.219	5.56	0.219	0.4	0.016	●
CPMT060202FP	CPMT21505FP	6.35	0.250	6.45	0.254	0.2	0.008	●
CPMT060204FP	CPMT2151FP	6.35	0.250	6.45	0.254	0.4	0.016	●
CPMT060208FP	CPMT2152FP	6.35	0.250	6.45	0.254	0.8	0.032	●
CPMT09T304FP	CPMT3251FP	9.53	0.375	9.67	0.381	0.4	0.016	●
CPMT09T308FP	CPMT3252FP	9.53	0.375	9.67	0.381	0.8	0.031	●

KCP25C

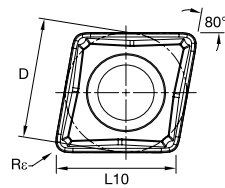
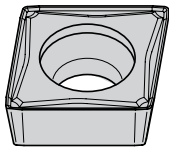

- Primär
- Sekundär

P	Blue	●
M	Yellow	○
K	Red	○
N	Green	○
S	Orange	○
H	Grey	○

Screw-On • CPMT-Wendeschneidplatte • Positiv • FW

ISO Katalognummer	ANSI Katalognummer	D		L10		Rε		● Primär ○ Sekundär
		mm	Zoll	mm	Zoll	mm	Zoll	
CPMT060208FW	CPMT2152FW	6.35	0.250	6.45	0.254	0.8	0.031	●
CPMT09T308FW	CPMT3252FW	9.53	0.375	9.67	0.381	0.8	0.031	●

KCP25C

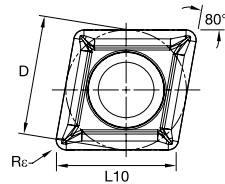
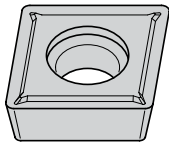

- Primär
- Sekundär

P	Blue	●
M	Yellow	○
K	Red	○
N	Green	○
S	Orange	○
H	Grey	○

Screw-On • CPMT-Wendeschneidplatte • Positiv • LF

ISO Katalognummer	ANSI Katalognummer	D		L10		Rε		● Primär ○ Sekundär
		mm	Zoll	mm	Zoll	mm	Zoll	
CPMT050204LF	CPMT18151LF	5.56	0.219	5.65	0.222	0.4	0.016	●
CPMT060202LF	CPMT21505LF	6.35	0.250	6.45	0.254	0.2	0.008	●
CPMT060204LF	CPMT2151LF	6.35	0.250	6.45	0.254	0.4	0.016	●
CPMT060208LF	CPMT2152LF	6.35	0.250	6.45	0.254	0.8	0.031	●
CPMT09T302LF	CPMT32505LF	9.53	0.375	9.67	0.381	0.2	0.008	●
CPMT09T304LF	CPMT3251LF	9.53	0.375	9.67	0.381	0.4	0.016	●
CPMT09T308LF	CPMT3252LF	9.53	0.375	9.67	0.381	0.8	0.031	●

KCP25C

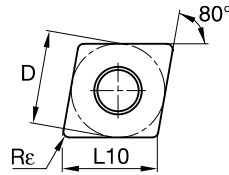
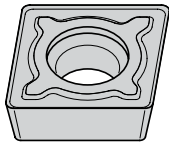

- Primär
- Sekundär

P	Blue	●
M	Yellow	○
K	Red	○
N	Green	○
S	Orange	○
H	Grey	○

Screw-On • CPMT-Wendeschnidplatte • Positiv • MF

ISO	ANSI	D		L10		Rε		KCP25C
Katalognummer	Katalognummer	mm	Zoll	mm	Zoll	mm	Zoll	
CPMT060208MF	CPMT2152MF	6.35	0.250	6.45	0.254	0.8	0.031	●
CPMT09T308MF	CPMT3252MF	9.53	0.375	9.67	0.381	0.8	0.031	●
CPMT09T312MF	CPMT3253MF	9.53	0.375	9.67	0.381	1.2	0.047	●

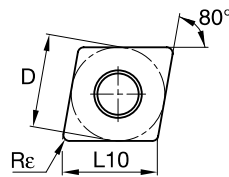
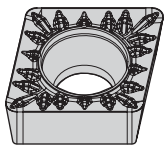

- Primär
- Sekundär

P	Blue	●
M	Yellow	○
K	Red	○
N	Green	○
S	Orange	○
H	Grey	○

Screw-On • CPMT-Wendeschnidplatte • Positiv • MP

ISO	ANSI	D		L10		Rε		KCP25C
Katalognummer	Katalognummer	mm	Zoll	mm	Zoll	mm	Zoll	
CPMT060208MP	CPMT2152MP	6.35	0.250	6.45	0.254	0.8	0.031	●
CPMT09T308MP	CPMT3252MP	9.53	0.375	9.67	0.381	0.8	0.031	●

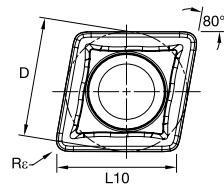
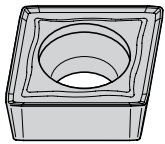

- Primär
- Sekundär

P	Blue	●
M	Yellow	○
K	Red	○
N	Green	○
S	Orange	○
H	Grey	○

Screw-On • CPMT-Wendeschnidplatte • Positiv • MW

ISO	ANSI	D		L10		R		KCP25C
Katalognummer	Katalognummer	mm	Zoll	mm	Zoll	mm	Zoll	
CPMT09T308MW	CPMT3252MW	9.53	0.375	9.67	0.381	0.8	0.031	●

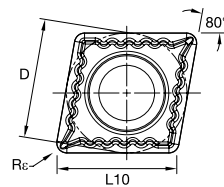
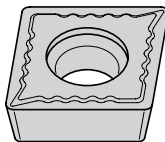

- Primär
- Sekundär

P	Blue	●
M	Yellow	○
K	Red	○
N	Green	○
S	Orange	○
H	Grey	○

Screw-On • CPMT-Wendeschnidplatte • Positiv • UF

ISO	ANSI	D		L10		Rε		KCP25C
Katalognummer	Katalognummer	mm	Zoll	mm	Zoll	mm	Zoll	
CPMT060204UF	CPMT2151UF	6.35	0.250	6.45	0.254	0.4	0.016	●
CPMT09T304UF	CPMT3251UF	9.53	0.375	9.67	0.381	0.4	0.016	●

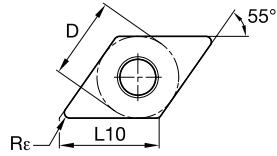
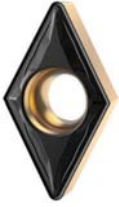

- Primär
- Sekundär

P	Blue	●
M	Yellow	○
K	Red	○
N	Green	○
S	Orange	○
H	Grey	○

Screw-On • DCMT-Wendeschnidplatte • Positiv • FP

ISO Katalognummer	ANSI Katalognummer	D		L10		Rε		● Primär ○ Sekundär
		mm	Zoll	mm	Zoll	mm	Zoll	
DCMT070202FP	DCMT21505FP	6.35	0.250	7.75	0.305	0.2	0.008	●
DCMT070204FP	DCMT2151FP	6.35	0.250	7.75	0.305	0.4	0.016	●
DCMT070208FP	DCMT2152FP	6.35	0.250	7.75	0.305	0.8	0.031	●
DCMT11T302FP	DCMT32505FP	9.53	0.375	11.63	0.458	0.2	0.008	●
DCMT11T304FP	DCMT3251FP	9.53	0.375	11.63	0.458	0.4	0.016	●
DCMT11T308FP	DCMT3252FP	9.53	0.375	11.63	0.458	0.8	0.031	●

KCP25C

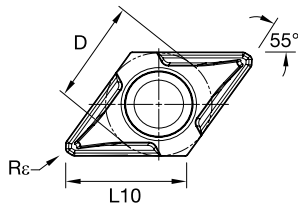
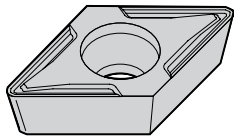

- Primär
- Sekundär

P	Blue	●
M	Yellow	○
K	Red	○
N	Green	○
S	Orange	○
H	Grey	○

Screw-On • DCMT-Wendeschnidplatte • Positiv • FW

ISO Katalognummer	ANSI Katalognummer	D		L10		Rε		● Primär ○ Sekundär
		mm	Zoll	mm	Zoll	mm	Zoll	
DCMT11T304FW	DCMT3251FW	9.53	0.375	11.63	0.458	0.4	0.016	●
DCMT11T308FW	DCMT3252FW	9.53	0.375	11.63	0.458	0.8	0.031	●

KCP25C

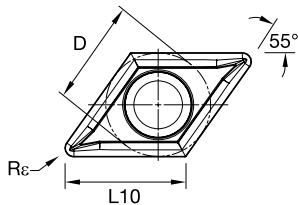
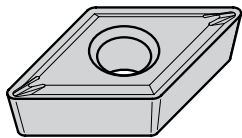

- Primär
- Sekundär

P	Blue	●
M	Yellow	○
K	Red	○
N	Green	○
S	Orange	○
H	Grey	○

Screw-On • DCMT-Wendeschnidplatte • Positiv • LF

ISO Katalognummer	ANSI Katalognummer	D		L10		R		● Primär ○ Sekundär
		mm	Zoll	mm	Zoll	mm	Zoll	
DCMT070202LF	DCMT21505LF	6.35	0.250	7.75	0.305	0.2	0.008	●
DCMT070204LF	DCMT2151LF	6.35	0.250	7.75	0.305	0.4	0.016	●
DCMT11T302LF	DCMT32505LF	9.53	0.375	11.63	0.458	0.2	0.008	●
DCMT11T304LF	DCMT3251LF	9.53	0.375	11.63	0.458	0.4	0.016	●
DCMT11T308LF	DCMT3252LF	9.53	0.375	11.63	0.458	0.8	0.031	●
DCMT11T312LF	DCMT3253LF	9.53	0.375	11.63	0.458	1.2	0.047	●
DCMT150404LF	DCMT431LF	12.70	0.500	15.50	0.610	0.4	0.016	●
DCMT150408LF	DCMT432LF	12.70	0.500	15.50	0.610	0.8	0.031	●

KCP25C

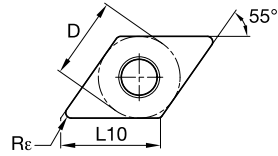
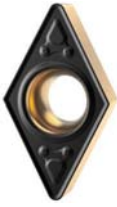

- Primär
- Sekundär

P	●
M	○
K	○
N	○
S	○
H	○

Screw-On • DCMT-Wendeschnidplatte • Positiv • MF

ISO	ANSI	D		L10		R		KCP25C
Katalognummer	Katalognummer	mm	Zoll	mm	Zoll	mm	Zoll	
DCMT11T304MF	DCMT3251MF	9.53	0.375	11.63	0.458	0.4	0.016	●
DCMT11T308MF	DCMT3252MF	9.53	0.375	11.63	0.458	0.8	0.031	●
DCMT11T312MF	DCMT3253MF	9.53	0.375	11.63	0.458	1.2	0.047	●

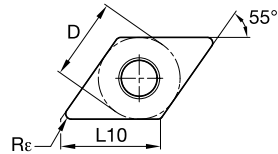
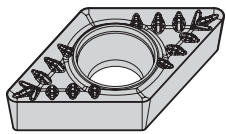

- Primär
- Sekundär

P	●
M	○
K	○
N	○
S	○
H	○

Screw-On • DCMT-Wendeschnidplatte • Positiv • MP

ISO	ANSI	D		L10		Rε		KCP25C
Katalognummer	Katalognummer	mm	Zoll	mm	Zoll	mm	Zoll	
DCMT11T304MP	DCMT3251MP	9.53	0.375	11.63	0.458	0.4	0.016	●
DCMT11T308MP	DCMT3252MP	9.53	0.375	11.63	0.458	0.8	0.031	●
DCMT11T312MP	DCMT3253MP	9.53	0.375	11.63	0.458	1.2	0.047	●

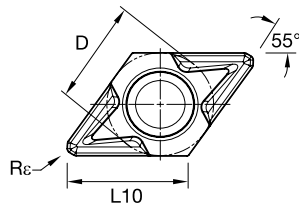
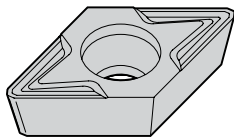

- Primär
- Sekundär

P	●
M	○
K	○
N	○
S	○
H	○

Screw-On • DCMT-Wendeschnidplatte • Positiv • MW

ISO	ANSI	D		L10		Rε		KCP25C
Katalognummer	Katalognummer	mm	Zoll	mm	Zoll	mm	Zoll	
DCMT11T308MW	DCMT3252MW	9.53	0.375	11.63	0.458	0.8	0.031	●

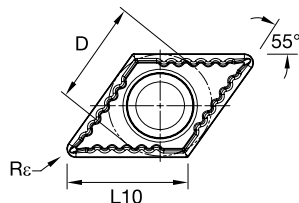

- Primär
- Sekundär

P	●
M	○
K	○
N	○
S	○
H	○

Screw-On • DCMT-Wendeschnidplatte • Positiv • UF

ISO	ANSI	D		L10		Rε		KCP25C
Katalognummer	Katalognummer	mm	Zoll	mm	Zoll	mm	Zoll	
DCMT070204UF	DCMT2151UF	6.35	0.250	7.75	0.305	0.4	0.016	●
DCMT11T304UF	DCMT3251UF	9.53	0.375	11.63	0.458	0.4	0.016	●
DCMT11T308UF	DCMT3252UF	9.53	0.375	11.63	0.458	0.8	0.031	●

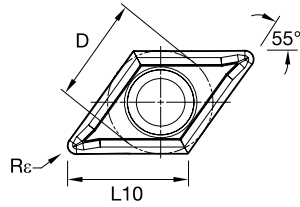
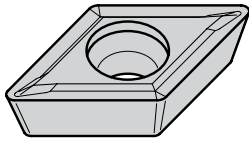

- Primär
- Sekundär

P	●
M	●
K	○
N	●
S	●
H	●

Screw-On • DPMT-Wendeschnidplatte • Positiv • LF

ISO	ANSI	D		L10		Rε		KCP25C
Katalognummer	Katalognummer	mm	Zoll	mm	Zoll	mm	Zoll	
DPMT070204LF	DPMT2151LF	6.35	0.250	7.75	0.305	0.4	0.016	●
DPMT11T304LF	DPMT3251LF	9.53	0.375	11.63	0.458	0.4	0.016	●
DPMT11T308LF	DPMT3252LF	9.53	0.375	11.63	0.458	0.8	0.031	●

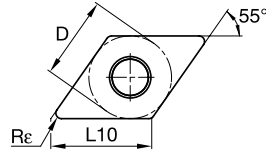
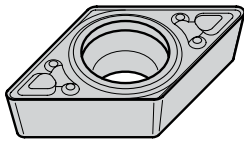

- Primär
- Sekundär

P	●
M	●
K	○
N	●
S	●
H	●

Screw-On • DPMT-Wendeschnidplatte • Positiv • MF

ISO	ANSI	D		L10		R		KCP25C
Katalognummer	Katalognummer	mm	Zoll	mm	Zoll	mm	Zoll	
DPMT11T308MF	DPMT3252MF	9.53	0.375	11.63	0.458	0.8	0.031	●

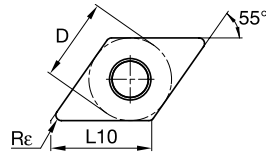
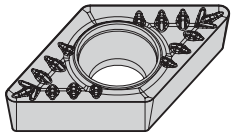

- Primär
- Sekundär

P	●
M	●
K	○
N	●
S	●
H	●

Screw-On • DPMT-Wendeschnidplatte • Positiv • MP

ISO	ANSI	D		L10		Rε		KCP25C
Katalognummer	Katalognummer	mm	Zoll	mm	Zoll	mm	Zoll	
DPMT11T308MP	DPMT3252MP	9.53	0.375	11.63	0.458	0.8	0.031	●

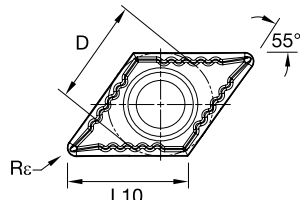
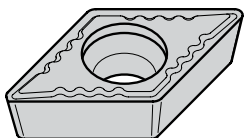

- Primär
- Sekundär

P	●
M	●
K	○
N	●
S	●
H	●

Screw-On • DPMT-Wendeschnidplatte • Positiv • UF

ISO	ANSI	D		L10		Rε		KCP25C
Katalognummer	Katalognummer	mm	Zoll	mm	Zoll	mm	Zoll	
DPMT070204UF	DPMT2151UF	6.35	0.250	7.75	0.305	0.4	0.016	●

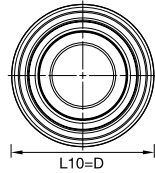
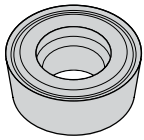

- Primär
- Sekundär

P	Blue	●
M	Yellow	●
K	Red	○
N	Green	●
S	Orange	●
H	Grey	●

Screw-On • RCGH-Wendeschneidplatte • Positiv

ISO	ANSI	D		L10		R _ε		KCP25C
Katalognummer	Katalognummer	mm	Zoll	mm	Zoll	mm	Zoll	
RCGH120400	RCGH43	12.70	0.500	-	-	-	-	●

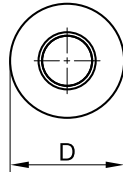
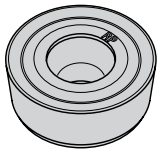

- Primär
- Sekundär

P	Blue	●
M	Yellow	●
K	Red	○
N	Green	●
S	Orange	●
H	Grey	●

Screw-On • RCGT-Wendeschneidplatte • Positiv • RP

ISO	ANSI	D		L10		R _ε		KCP25C
Katalognummer	Katalognummer	mm	Zoll	mm	Zoll	mm	Zoll	
RCGT0602MORP	RCGT0602MORP	6.00	0.236	-	-	-	-	●
RCGT0803MORP	RCGT0803MORP	8.00	0.315	-	-	-	-	●
RCGT1204MORP	RCGT1204MORP	12.00	0.472	-	-	-	-	●

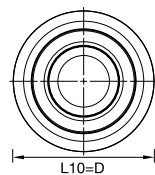
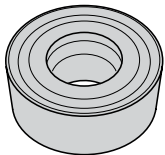

- Primär
- Sekundär

P	Blue	●
M	Yellow	●
K	Red	○
N	Green	●
S	Orange	●
H	Grey	●

Screw-On • RCMT-Wendeschneidplatte • Positiv

ISO	ANSI	D		L10		R _ε		KCP25C
Katalognummer	Katalognummer	mm	Zoll	mm	Zoll	mm	Zoll	
RCMT060200	RCMT215	6.35	0.250	-	-	-	-	●
RCMT0602M0	RCMT0602M0	6.00	0.236	-	-	-	-	●
RCMT0803M0	RCMT0803M0	8.00	0.315	-	-	-	-	●
RCMT09T300	RCMT325	9.53	0.375	-	-	-	-	●
RCMT10T3M0	RCMT10T3M0	10.00	0.394	-	-	-	-	●
RCMT1204M0	RCMT1204M0	12.00	0.472	-	-	-	-	●
RCMT1605M0	RCMT1605M0	16.00	0.630	-	-	-	-	●
RCMT2006M0	RCMT2006M0	20.00	0.787	-	-	-	-	●

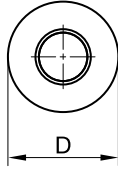

- Primär
- Sekundär

P	Blue	●
M	Yellow	●
K	Red	○
N	Green	●
S	Orange	●
H	Grey	●

Screw-On • RCMT-Wendeschnidplatte • Positiv • RH

ISO	ANSI	D		L10		Rε		KCP25C
Katalognummer	Katalognummer	mm	Zoll	mm	Zoll	mm	Zoll	
RCMT2006M0RH	RCMT2006M0RH	20.00	0.787	-	-	-	-	●

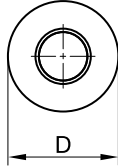
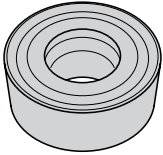

- Primär
- Sekundär

P	Blue	●
M	Yellow	●
K	Red	○
N	Green	●
S	Orange	●
H	Grey	●

Screw-On • RCMT-Wendeschnidplatte • Positiv • RM

ISO	ANSI	D		L10		Rε		KCP25C
Katalognummer	Katalognummer	mm	Zoll	mm	Zoll	mm	Zoll	
RCMT2006M0RM	RCMT2006M0RM	20.00	0.787	-	-	-	-	●

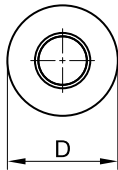
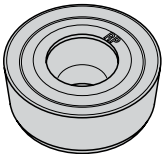

- Primär
- Sekundär

P	Blue	●
M	Yellow	●
K	Red	○
N	Green	●
S	Orange	●
H	Grey	●

Screw-On • RCMT-Wendeschnidplatte • Positiv • RP

ISO	ANSI	D		L10		Rε		KCP25C
Katalognummer	Katalognummer	mm	Zoll	mm	Zoll	mm	Zoll	
RCMT1204M0RP	RCMT1204M0RP	12.00	0.472	-	-	-	-	●
RCMT1606M0RP	RCMT1606M0RP	16.00	0.630	-	-	-	-	●
RCMT2006M0RP	RCMT2006M0RP	20.00	0.787	-	-	-	-	●

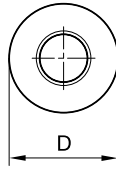
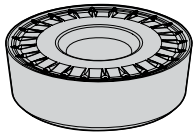

- Primär
- Sekundär

P	●
M	○
K	○
N	○
S	○
H	○

Screw-On • RCMT-Wendeschnleidplatte • Positiv • UP

ISO	ANSI	D		L10		R		KCP25C
Katalognummer	Katalognummer	mm	Zoll	mm	Zoll	mm	Zoll	
RCMT1204M0UP	RCMT1204M0UP	12.00	0.472	-	-	-	-	●

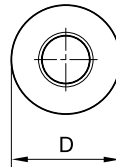
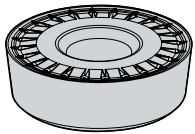

- Primär
- Sekundär

P	●
M	○
K	○
N	○
S	○
H	○

Screw-On • RCMT-Wendeschnleidplatte • Positiv • UPG

ISO	ANSI	D		L10		R _ε		KCP25C
Katalognummer	Katalognummer	mm	Zoll	mm	Zoll	mm	Zoll	
RCMT1606M0UPG	RCMT1606M0UPG	16.00	0.630	-	-	-	-	●
RCMT2006M0UPG	RCMT2006M0UPG	20.00	0.787	-	-	-	-	●

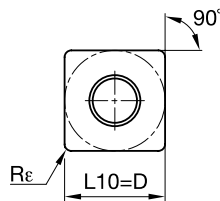
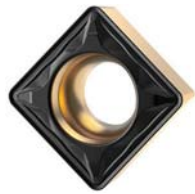

- Primär
- Sekundär

P	●
M	○
K	○
N	○
S	○
H	○

Screw-On • SCMT-Wendeschnleidplatte • Positiv • FP

ISO	ANSI	D		L10		R _ε		KCP25C
Katalognummer	Katalognummer	mm	Zoll	mm	Zoll	mm	Zoll	
SCMT09T304FP	SCMT3251FP	9.53	0.375	9.53	0.375	0.4	0.016	●
SCMT09T308FP	SCMT3252FP	9.53	0.375	9.53	0.375	0.8	0.031	●
SCMT120404FP	SCMT431FP	12.70	0.500	12.70	0.500	0.4	0.016	●
SCMT120408FP	SCMT432FP	12.70	0.500	12.70	0.500	0.8	0.031	●
SCMT120412FP	SCMT433FP	12.70	0.500	12.70	0.500	1.2	0.047	●

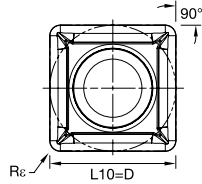
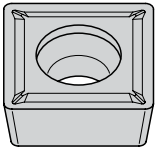

- Primär
- Sekundär

P	Blue	●
M	Yellow	○
K	Red	○
N	Green	○
S	Orange	○
H	Grey	○

Screw-On • SCMT-Wendeschnidplatte • Positiv • LF

ISO Katalognummer	ANSI Katalognummer	D		L10		Rε		
		mm	Zoll	mm	Zoll	mm	Zoll	
SCMT09T304LF	SCMT3251LF	9.53	0.375	9.53	0.375	0.4	0.016	●
SCMT09T308LF	SCMT3252LF	9.53	0.375	9.53	0.375	0.8	0.031	●
SCMT120404LF	SCMT431LF	12.70	0.500	12.70	0.500	0.4	0.016	●
SCMT120408LF	SCMT432LF	12.70	0.500	12.70	0.500	0.8	0.031	●
SCMT120412LF	SCMT433LF	12.70	0.500	12.70	0.500	1.2	0.047	●

KCP25C

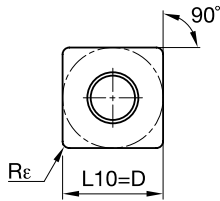
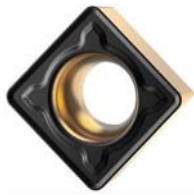

- Primär
- Sekundär

P	Blue	●
M	Yellow	○
K	Red	○
N	Green	○
S	Orange	○
H	Grey	○

Screw-On • SCMT-Wendeschnidplatte • Positiv • MF

ISO Katalognummer	ANSI Katalognummer	D		L10		Rε		
		mm	Zoll	mm	Zoll	mm	Zoll	
SCMT09T308MF	SCMT3252MF	9.53	0.375	9.53	0.375	0.8	0.031	●
SCMT09T312MF	SCMT3253MF	9.53	0.375	9.53	0.375	1.2	0.047	●
SCMT120404MF	SCMT431MF	12.70	0.500	12.70	0.500	0.4	0.016	●
SCMT120408MF	SCMT432MF	12.70	0.500	12.70	0.500	0.8	0.031	●
SCMT120412MF	SCMT433MF	12.70	0.500	12.70	0.500	1.2	0.047	●

KCP25C

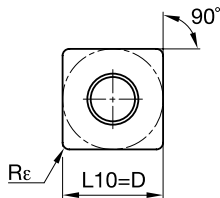
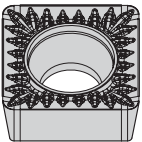

- Primär
- Sekundär

P	Blue	●
M	Yellow	○
K	Red	○
N	Green	○
S	Orange	○
H	Grey	○

Screw-On • SCMT-Wendeschnidplatte • Positiv • MP

ISO Katalognummer	ANSI Katalognummer	D		L10		Rε		
		mm	Zoll	mm	Zoll	mm	Zoll	
SCMT09T304MP	SCMT3251MP	9.53	0.375	9.53	0.375	0.4	0.016	●
SCMT09T308MP	SCMT3252MP	9.53	0.375	9.53	0.375	0.8	0.031	●
SCMT120408MP	SCMT432MP	12.70	0.500	12.70	0.500	0.8	0.031	●

KCP25C

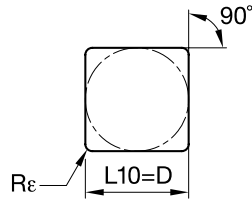
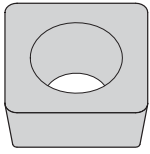

- Primär
- Sekundär

P	Blue	●
M	Yellow	○
K	Red	○
N	Green	○
S	Orange	○
H	Grey	○

Screw-On • SPGT-Wendeschnidplatte • Positiv • K

ISO	ANSI	D		L10		Rε		KCP25C
Katalognummer	Katalognummer	mm	Zoll	mm	Zoll	mm	Zoll	
SPGT060212K	SPGM2153	6.35	0.250	6.35	0.250	1.2	0.047	●

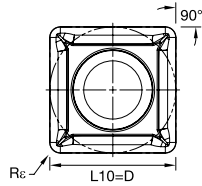
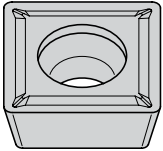

- Primär
- Sekundär

P	Blue	●
M	Yellow	○
K	Red	○
N	Green	○
S	Orange	○
H	Grey	○

Screw-On • SPMT-Wendeschnidplatte • Positiv • LF

ISO	ANSI	D		L10		Rε		KCP25C
Katalognummer	Katalognummer	mm	Zoll	mm	Zoll	mm	Zoll	
SPMT09T304LF	SPMT3251LF	9.53	0.375	9.53	0.375	0.4	0.016	●
SPMT09T308LF	SPMT3252LF	9.53	0.375	9.53	0.375	0.8	0.031	●

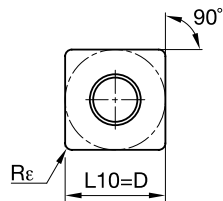
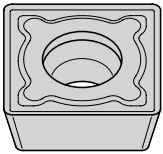

- Primär
- Sekundär

P	Blue	●
M	Yellow	○
K	Red	○
N	Green	○
S	Orange	○
H	Grey	○

Screw-On • SPMT-Wendeschnidplatte • Positiv • MF

ISO	ANSI	D		L10		Rε		KCP25C
Katalognummer	Katalognummer	mm	Zoll	mm	Zoll	mm	Zoll	
SPMT09T308MF	SPMT3252MF	9.53	0.375	9.53	0.375	0.8	0.031	●
SPMT120408MF	SPMT432MF	12.70	0.500	12.70	0.500	0.8	0.031	●

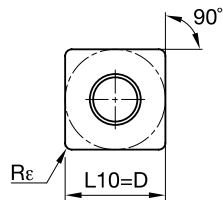
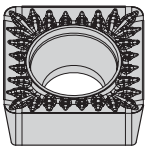

- Primär
- Sekundär

P	Blue	●
M	Yellow	○
K	Red	○
N	Green	○
S	Orange	○
H	Grey	○

Screw-On • SPMT-Wendeschnidplatte • Positiv • MP

ISO	ANSI	D		L10		Rε		KCP25C
Katalognummer	Katalognummer	mm	Zoll	mm	Zoll	mm	Zoll	
SPMT120408MP	SPMT432MP	12.70	0.500	12.70	0.500	0.8	0.031	●

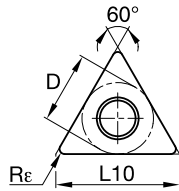
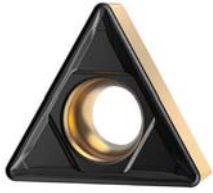

- Primär
- Sekundär

P	●
M	○
K	○
N	○
S	○
H	○

Screw-On • TCMT-Wendeschneidplatte • Positiv • FP

ISO Katalognummer	ANSI Katalognummer	D		L10		R		KCP25C
		mm	Zoll	mm	Zoll	mm	Zoll	
TCMT090204FP	TCMT18151FP	5.56	0.219	9.62	0.379	0.4	0.016	●
TCMT110204FP	TCMT2151FP	6.35	0.250	11.00	0.433	0.4	0.016	●
TCMT110208FP	TCMT2152FP	6.35	0.250	11.00	0.433	0.8	0.031	●
TCMT16T304FP	TCMT3251FP	9.53	0.375	16.50	0.650	0.4	0.016	●
TCMT16T308FP	TCMT3252FP	9.53	0.375	16.50	0.650	0.8	0.031	●
TCMT220408FP	TCMT432FP	12.70	0.500	22.00	0.866	0.8	0.031	●

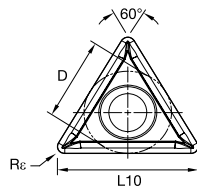
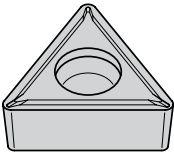

- Primär
- Sekundär

P	●
M	○
K	○
N	○
S	○
H	○

Screw-On • TCMT-Wendeschneidplatte • Positiv • LF

ISO Katalognummer	ANSI Katalognummer	D		L10		Rε		KCP25C
		mm	Zoll	mm	Zoll	mm	Zoll	
TCMT110204LF	TCMT2151LF	6.35	0.250	11.00	0.433	0.4	0.016	●
TCMT110208LF	TCMT2152LF	6.35	0.250	11.00	0.433	0.8	0.031	●
TCMT16T304LF	TCMT3251LF	9.53	0.375	16.50	0.650	0.4	0.016	●
TCMT16T308LF	TCMT3252LF	9.53	0.375	16.50	0.650	0.8	0.031	●
TCMT16T312LF	TCMT3253LF	9.53	0.375	16.50	0.650	1.2	0.047	●
TCMT220408LF	TCMT432LF	12.70	0.500	22.00	0.866	0.8	0.031	●

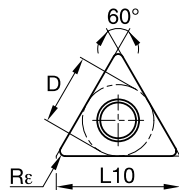
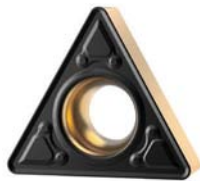

- Primär
- Sekundär

P	●
M	○
K	○
N	○
S	○
H	○

Screw-On • TCMT-Wendeschneidplatte • Positiv • MF

ISO Katalognummer	ANSI Katalognummer	D		L10		Rε		KCP25C
		mm	Zoll	mm	Zoll	mm	Zoll	
TCMT110204MF	TCMT2151MF	6.35	0.250	11.00	0.433	0.4	0.016	●
TCMT110208MF	TCMT2152MF	6.35	0.250	11.00	0.433	0.8	0.031	●
TCMT16T308MF	TCMT3252MF	9.53	0.375	16.50	0.650	0.8	0.031	●
TCMT16T312MF	TCMT3253MF	9.53	0.375	16.50	0.650	1.2	0.047	●

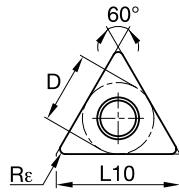
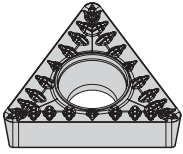

- Primär
- Sekundär

P	●
M	○
K	○
N	○
S	○
H	○

Screw-On • TCMT-Wendeschnidplatte • Positiv • MP

ISO	ANSI	D		L10		R		KCP25C
Katalognummer	Katalognummer	mm	Zoll	mm	Zoll	mm	Zoll	
TCMT110208MP	TCMT2152MP	6.35	0.250	11.00	0.433	0.8	0.031	●
TCMT16T304MP	TCMT3251MP	9.53	0.375	16.50	0.650	0.4	0.016	●
TCMT16T308MP	TCMT3252MP	9.53	0.375	16.50	0.650	0.8	0.031	●
TCMT16T312MP	TCMT3253MP	9.53	0.375	16.50	0.650	1.2	0.047	●

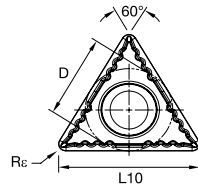
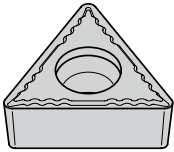

- Primär
- Sekundär

P	●
M	○
K	○
N	○
S	○
H	○

Screw-On • TCMT-Wendeschnidplatte • Positiv • UF

ISO	ANSI	D		L10		Rε		KCP25C
Katalognummer	Katalognummer	mm	Zoll	mm	Zoll	mm	Zoll	
TCMT16T308UF	TCMT3252UF	9.53	0.375	16.50	0.650	0.8	0.031	●

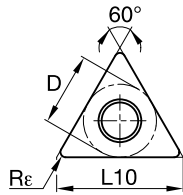
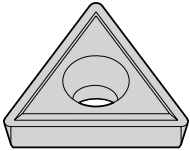

- Primär
- Sekundär

P	●
M	○
K	○
N	○
S	○
H	○

Screw-On • TPGM-Wendeschnidplatte • Positiv

ISO	ANSI	D		L10		Rε		KCP25C
Katalognummer	Katalognummer	mm	Zoll	mm	Zoll	mm	Zoll	
TPGT110204K	TPGM2151	6.35	0.250	11.00	0.433	0.4	0.016	●
TPGT110208K	TPGM2152	6.35	0.250	11.00	0.433	0.8	0.031	●

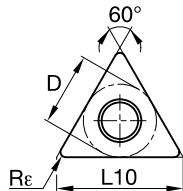
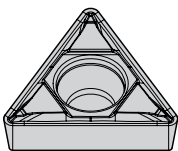

- Primär
- Sekundär

P	●
M	○
K	○
N	○
S	○
H	○

Screw-On • TPMT-Wendeschnidplatte • Positiv • FP

ISO	ANSI	D		L10		R		KCP25C
Katalognummer	Katalognummer	mm	Zoll	mm	Zoll	mm	Zoll	
TPMT090208FP	TPMT18152FP	5.56	0.219	9.63	0.379	0.8	0.031	●
TPMT110204FP	TPMT2151FP	6.35	0.250	11.00	0.433	0.4	0.016	●
TPMT16T304FP	TPMT3251FP	9.53	0.375	16.50	0.650	0.4	0.016	●
TPMT16T308FP	TPMT3252FP	9.53	0.375	16.50	0.650	0.8	0.031	●

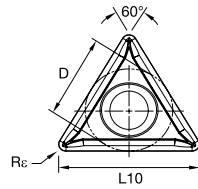
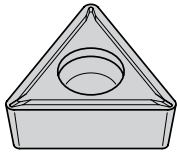

- Primär
- Sekundär

P	Blue	●
M	Yellow	○
K	Red	○
N	Green	○
S	Orange	○
H	Grey	○

Screw-On • TPMT-Wendeschneidplatte • Positiv • LF

ISO Katalognummer	ANSI Katalognummer	D		L10		Rε		● Primär ○ Sekundär
		mm	Zoll	mm	Zoll	mm	Zoll	
TPMT090204LF	TPMT18151LF	5.56	0.219	9.63	0.379	0.4	0.016	●
TPMT110204LF	TPMT2151LF	6.35	0.250	11.00	0.433	0.4	0.016	●
TPMT110208LF	TPMT2152LF	6.35	0.250	11.00	0.433	0.8	0.031	●
TPMT16T304LF	TPMT3251LF	9.53	0.375	16.50	0.650	0.4	0.016	●
TPMT16T308LF	TPMT3252LF	9.53	0.375	16.50	0.650	0.8	0.031	●

KCP25C

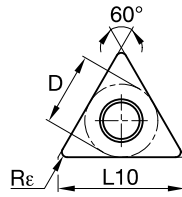
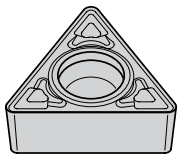

- Primär
- Sekundär

P	Blue	●
M	Yellow	○
K	Red	○
N	Green	○
S	Orange	○
H	Grey	○

Screw-On • TPMT-Wendeschneidplatte • Positiv • MF

ISO Katalognummer	ANSI Katalognummer	D		L10		Rε		● Primär ○ Sekundär
		mm	Zoll	mm	Zoll	mm	Zoll	
TPMT110208MF	TPMT2152MF	6.35	0.250	11.00	0.433	0.8	0.031	●
TPMT16T308MF	TPMT3252MF	9.53	0.375	16.50	0.650	0.8	0.031	●
TPMT16T312MF	TPMT3253MF	9.53	0.375	16.50	0.650	1.2	0.047	●

KCP25C

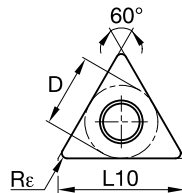
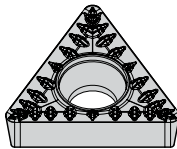

- Primär
- Sekundär

P	Blue	●
M	Yellow	○
K	Red	○
N	Green	○
S	Orange	○
H	Grey	○

Screw-On • TPMT-Wendeschneidplatte • Positiv • MP

ISO Katalognummer	ANSI Katalognummer	D		L10		R		● Primär ○ Sekundär
		mm	Zoll	mm	Zoll	mm	Zoll	
TPMT110208MP	TPMT2152MP	6.35	0.250	11.00	0.433	0.8	0.031	●
TPMT16T308MP	TPMT3252MP	9.53	0.375	16.50	0.650	0.8	0.031	●
TPMT16T312MP	TPMT3253MP	9.53	0.375	16.50	0.650	1.2	0.047	●

KCP25C

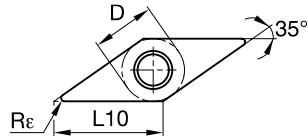

- Primär
- Sekundär

P	●
M	○
K	○
N	○
S	○
H	○

Screw-On • VBMT-Wendeschneidplatte • Positiv • FP

ISO Katalognummer	ANSI Katalognummer	D		L10		Rε		KCP25C
		mm	Zoll	mm	Zoll	mm	Zoll	
VBMT110302FP	VBMT2205FP	6.35	0.250	11.07	0.436	0.2	0.008	●
VBMT110304FP	VBMT221FP	6.35	0.250	11.07	0.436	0.4	0.016	●
VBMT110308FP	VBMT222FP	6.35	0.250	11.07	0.436	0.8	0.031	●
VBMT160402FP	VBMT3305FP	9.53	0.375	16.61	0.654	0.2	0.008	●
VBMT160404FP	VBMT331FP	9.53	0.375	16.61	0.654	0.4	0.016	●
VBMT160408FP	VBMT332FP	9.53	0.375	16.61	0.654	0.8	0.031	●
VBMT160412FP	VBMT333FP	9.53	0.375	16.61	0.654	1.2	0.047	●

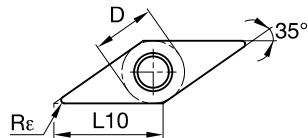
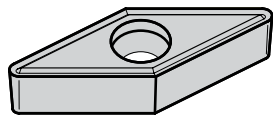

- Primär
- Sekundär

P	●
M	○
K	○
N	○
S	○
H	○

Screw-On • VBMT-Wendeschneidplatte • Positiv • LF

ISO Katalognummer	ANSI Katalognummer	D		L10		Rε		KCP25C
		mm	Zoll	mm	Zoll	mm	Zoll	
VBMT110304LF	VBMT221LF	6.35	0.250	11.07	0.436	0.4	0.016	●
VBMT110308LF	VBMT222LF	6.35	0.250	11.07	0.436	0.8	0.031	●
VBMT160402LF	VBMT3305LF	9.53	0.375	16.61	0.654	0.2	0.008	●
VBMT160404LF	VBMT331LF	9.53	0.375	16.61	0.654	0.4	0.016	●
VBMT160408LF	VBMT332LF	9.53	0.375	16.61	0.654	0.8	0.031	●
VBMT160412LF	VBMT333LF	9.53	0.375	16.61	0.654	1.2	0.047	●

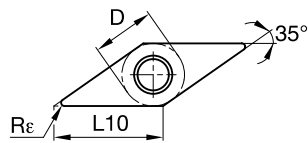
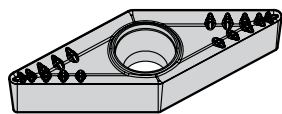

- Primär
- Sekundär

P	●
M	○
K	○
N	○
S	○
H	○

Screw-On • VBMT-Wendeschneidplatte • Positiv • MP

ISO Katalognummer	ANSI Katalognummer	D		L10		Rε		KCP25C
		mm	Zoll	mm	Zoll	mm	Zoll	
VBMT160404MP	VBMT331MP	9.53	0.375	16.61	0.654	0.4	0.016	●
VBMT160408MP	VBMT332MP	9.53	0.375	16.61	0.654	0.8	0.031	●

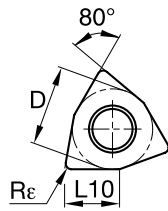
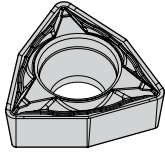

- Primär
- Sekundär

P	Blue	●
M	Yellow	○
K	Red	○
N	Green	○
S	Orange	○
H	Grey	○

Screw-On • WCMT-Wendeschneidplatte • Positiv • FP

ISO	ANSI	D		L10		Rε		KCP25C
Katalognummer	Katalognummer	mm	Zoll	mm	Zoll	mm	Zoll	
WCMT06T308FP	WCMT3252FP	9.53	0.375	6.52	0.257	0.8	0.031	●

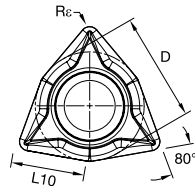
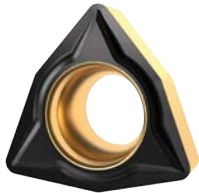

- Primär
- Sekundär

P	Blue	●
M	Yellow	○
K	Red	○
N	Green	○
S	Orange	○
H	Grey	○

Screw-On • WPMT-Wendeschneidplatte • Positiv • LF

ISO	ANSI	D		L10		Rε		KCP25C
Katalognummer	Katalognummer	mm	Zoll	mm	Zoll	mm	Zoll	
WPMT06T304LF	WPMT3251LF	9.53	0.375	6.52	0.257	0.4	0.016	●
WPMT06T308LF	WPMT3252LF	9.53	0.375	6.52	0.257	0.8	0.031	●
WPMTS3T104LF	WPMT15121LF	4.76	0.188	3.26	0.128	0.4	0.016	●

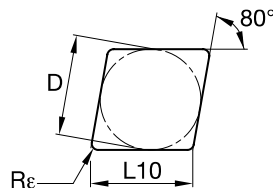
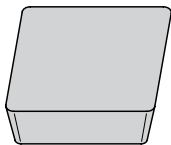

- Primär
- Sekundär

P	Blue	●
M	Yellow	○
K	Red	○
N	Green	○
S	Orange	○
H	Grey	○

Kendex™ • CPG-Wendeschneidplatte • Positiv

ISO	ANSI	D		L10		Rε		KCP25C
Katalognummer	Katalognummer	mm	Zoll	mm	Zoll	mm	Zoll	
CPGN120304	CPG421	12.70	0.500	12.90	0.508	0.4	0.016	●
CPGN120308	CPG422	12.70	0.500	12.90	0.508	0.8	0.031	●

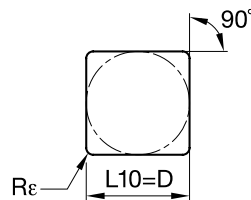
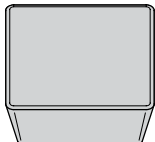

- Primär
- Sekundär

P	Blue	●
M	Yellow	○
K	Red	○
N	Green	○
S	Orange	○
H	Grey	○

Kendex™ • SPGN-Wendeschneidplatte • Positiv

ISO	ANSI	D		L10		Rε		KCP25C
Katalognummer	Katalognummer	mm	Zoll	mm	Zoll	mm	Zoll	
SPGN120304	SPG421	12.70	0.500	12.70	0.500	0.4	0.016	●
SPGN120308	SPG422	12.70	0.500	12.70	0.500	0.8	0.031	●
SPGN190408	SPG632	19.05	0.750	19.05	0.750	0.8	0.031	●
SPGN190412	SPG633	19.05	0.750	19.05	0.750	1.2	0.047	●
SPGN190416	SPG634	19.05	0.750	19.05	0.750	1.6	0.063	●

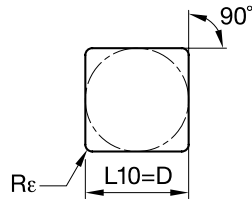
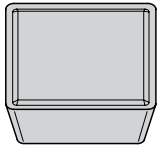

- Primär
- Sekundär

P	Blue	●
M	Yellow	○
K	Red	○
N	Green	○
S	Orange	○
H	Grey	○

Kendex™ • SPGF-Wendeschnidplatte • Positiv

ISO	ANSI	D		L10		Rε		KCP25C
Katalognummer	Katalognummer	mm	Zoll	mm	Zoll	mm	Zoll	
SPGR090308K	SPGF322	9.53	0.375	9.53	0.375	0.8	0.031	●

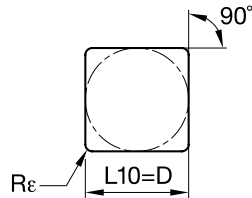
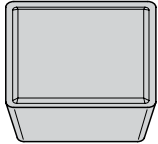

- Primär
- Sekundär

P	Blue	●
M	Yellow	○
K	Red	○
N	Green	○
S	Orange	○
H	Grey	○

Kendex™ • SPMR-Wendeschnidplatte • Positiv

ISO	ANSI	D		L10		Rε		KCP25C
Katalognummer	Katalognummer	mm	Zoll	mm	Zoll	mm	Zoll	
SPMR090308	SPMR322	9.53	0.375	9.53	0.375	0.8	0.031	●
SPMR120304	SPMR421	12.70	0.500	12.70	0.500	0.4	0.016	●
SPMR120308	SPMR422	12.70	0.500	12.70	0.500	0.8	0.031	●

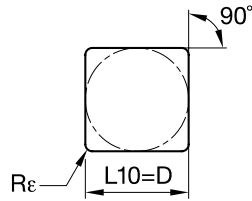
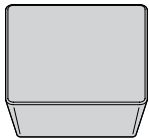

- Primär
- Sekundär

P	Blue	●
M	Yellow	○
K	Red	○
N	Green	○
S	Orange	○
H	Grey	○

Kendex™ • SPU-Wendeschnidplatte • Positiv

ISO	ANSI	D		L10		Rε		KCP25C
Katalognummer	Katalognummer	mm	Zoll	mm	Zoll	mm	Zoll	
SPUN120304	SPU421	12.70	0.500	12.70	0.500	0.4	0.016	●
SPUN120308	SPU422	12.70	0.500	12.70	0.500	0.8	0.031	●
SPUN190412	SPU633	19.05	0.750	19.05	0.750	1.2	0.047	●

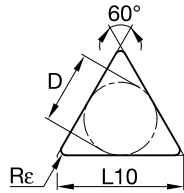

- Primär
- Sekundär

P	Blue	●
M	Yellow	●
K	Red	○
N	Green	●
S	Orange	●
H	Grey	●

Kendex™ • TPG-Wendeschnidplatte • Positiv

ISO Katalognummer	ANSI Katalognummer	D		L10		Re		● Primär ○ Sekundär
		mm	Zoll	mm	Zoll	mm	Zoll	
TPGN160304	TPG321	9.53	0.375	16.50	0.650	0.4	0.016	●
TPGN160308	TPG322	9.53	0.375	16.50	0.650	0.8	0.031	●
TPGN160312	TPG323	9.53	0.375	16.50	0.650	1.2	0.047	●
TPGN160316	TPG324	9.53	0.375	16.50	0.650	1.6	0.063	●
TPGN220404	TPG431	12.70	0.500	22.00	0.866	0.4	0.016	●
TPGN220408	TPG432	12.70	0.500	22.00	0.866	0.8	0.031	●
TPGN220412	TPG433	12.70	0.500	22.00	0.866	1.2	0.047	●
TPGN270608	TPG542	15.88	0.625	27.50	1.083	0.8	0.031	●
TPGN270612	TPG543	15.88	0.625	27.50	1.083	1.2	0.047	●

KCP25C

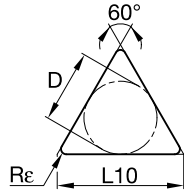
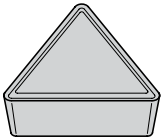

- Primär
- Sekundär

P	Blue	●
M	Yellow	●
K	Red	○
N	Green	●
S	Orange	●
H	Grey	●

Kendex™ • TPGF-Wendeschnidplatte • Positiv

ISO Katalognummer	ANSI Katalognummer	D		L10		Re		● Primär ○ Sekundär
		mm	Zoll	mm	Zoll	mm	Zoll	
TPGR160304K	TPGF321	9.53	0.375	13.89	0.547	0.4	0.016	●
TPGR220404K	TPGF431	12.70	0.500	22.00	0.866	0.4	0.016	●
TPGR220408K	TPGF432	12.70	0.500	22.00	0.866	0.8	0.031	●

KCP25C

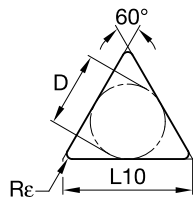
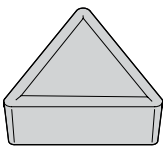

- Primär
- Sekundär

P	Blue	●
M	Yellow	●
K	Red	○
N	Green	●
S	Orange	●
H	Grey	●

Kendex™ • TPGR-Wendeschnidplatte • Positiv

ISO Katalognummer	ANSI Katalognummer	D		L10		Re		● Primär ○ Sekundär
		mm	Zoll	mm	Zoll	mm	Zoll	
TPMR160304	TPMR321	9.53	0.375	16.50	0.650	0.4	0.016	●
TPMR160308	TPMR322	9.53	0.375	16.50	0.650	0.8	0.031	●
TPMR220412	TPMR433	12.70	0.500	22.00	0.866	1.2	0.047	●

KCP25C

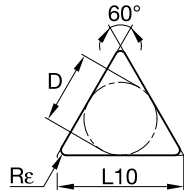
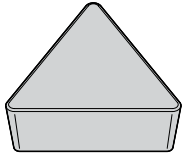

- Primär
- Sekundär

P	●
M	○
K	○
N	○
S	○
H	○

Kendex™ • TPU-Wendeschnleidplatte • Positiv

ISO	ANSI	D		L10		Rε		KCP25C
Katalognummer	Katalognummer	mm	Zoll	mm	Zoll	mm	Zoll	
TPUN160304	TPU321	9.53	0.375	16.50	0.650	0.4	0.016	●
TPUN160308	TPU322	9.53	0.375	16.50	0.650	0.8	0.031	●
TPUN220408	TPU432	12.70	0.500	22.00	0.866	0.8	0.031	●
TPUN220412	TPU433	12.70	0.500	22.00	0.866	1.2	0.047	●

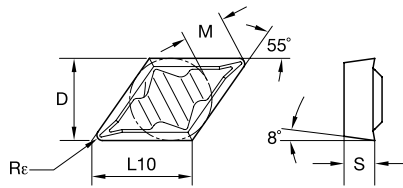
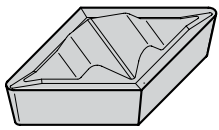

- Primär
- Sekundär

P	●
M	○
K	○
N	○
S	○
H	○

Top Notch™ Profildrehen • DCGR • DPGR

ISO	ANSI	D		L10		S		M		Rε		KCP25C
Katalognummer	Katalognummer	mm	Zoll	mm	Zoll	mm	Zoll	mm	Zoll	mm	Zoll	
DCGR150408	DPGR432	12.70	0.500	15.50	0.610	4.76	0.188	6.48	0.255	0.8	0.031	●

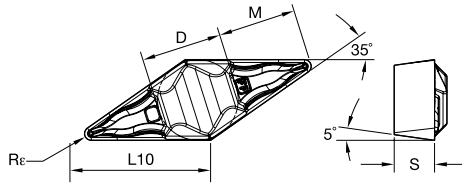

- Primär
- Sekundär

P	●
M	○
K	○
N	○
S	○
H	○

Top Notch™ Profildrehen • VBMR-FP

ISO	ANSI	D		L10		S		M		Rε		KCP25C
Katalognummer	Katalognummer	mm	Zoll	mm	Zoll	mm	Zoll	mm	Zoll	mm	Zoll	
VBMR110304FP	VBMR221FP	6.35	0.250	11.07	0.436	3.18	0.125	6.46	0.254	0.4	0.016	●

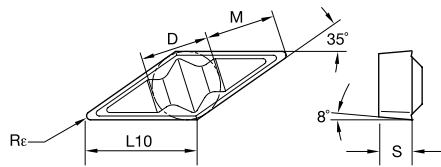
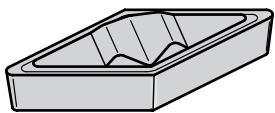

- Primär
- Sekundär

P	●
M	○
K	○
N	○
S	○
H	○

Top Notch™ Profildrehen • VCMR

ISO	ANSI	D		L10		S		M		Rε		KCP25C
Katalognummer	Katalognummer	mm	Zoll	mm	Zoll	mm	Zoll	mm	Zoll	mm	Zoll	
VCMR160404	VCMR331	9.53	0.375	16.61	0.654	4.76	0.188	10.15	0.400	0.4	0.016	●
VCMR160408	VCMR332	9.53	0.375	16.61	0.654	4.76	0.188	9.23	0.363	0.8	0.031	●

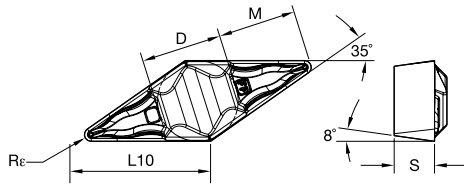

- Primär
- Sekundär

P	●
M	○
K	○
N	○
S	○
H	○

Top Notch™ Profildrehen • VCMR-FP

ISO	ANSI	D		L10		S		M		Rε		KCP25C
Katalognummer	Katalognummer	mm	Zoll	mm	Zoll	mm	Zoll	mm	Zoll	mm	Zoll	
VCMR160404FP	VCMR331FP	9.52	0.375	16.61	0.654	4.76	0.188	10.15	0.400	0.4	0.016	●
VCMR160408FP	VCMR332FP	9.52	0.375	16.61	0.654	4.76	0.188	9.23	0.363	0.8	0.031	●

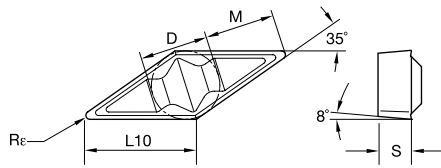
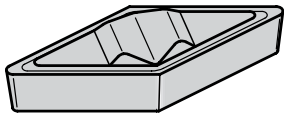

- Primär
- Sekundär

P	●
M	○
K	○
N	○
S	○
H	○

Top Notch™ Profildrehen • VCGR • VPGR

ISO	ANSI	D		L10		S		M		Rε		KCP25C
Katalognummer	Katalognummer	mm	Zoll	mm	Zoll	mm	Zoll	mm	Zoll	mm	Zoll	
VCGR160404	VPGR331	9.53	0.375	16.61	0.654	4.76	0.188	10.15	0.400	0.4	0.016	●
VCGR160408	VPGR332	9.52	0.375	16.61	0.654	4.76	0.188	9.23	0.363	0.8	0.031	●

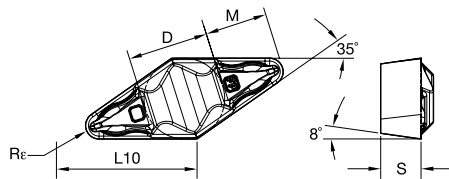

- Primär
- Sekundär

P	●
M	○
K	○
N	○
S	○
H	○

Top Notch™ Profildrehen • VCGR-FP • VPGR-FP

ISO	ANSI	D		L10		S		M		Rε		KCP25C
Katalognummer	Katalognummer	mm	Zoll	mm	Zoll	mm	Zoll	mm	Zoll	mm	Zoll	
VCGR160404FP	VPGR331FP	9.52	0.375	16.61	0.654	4.76	0.188	10.15	0.400	0.4	0.016	●
VCGR160408FP	VPGR332FP	9.52	0.375	16.61	0.654	4.76	0.188	9.23	0.363	0.8	0.031	●
VCGR160412FP	VPGR333FP	9.53	0.375	16.61	0.654	4.76	0.188	8.31	0.327	1.2	0.047	●
VCGR160416FP	VPGR334FP	9.53	0.375	16.61	0.654	4.76	0.188	7.38	0.291	1.6	0.063	●

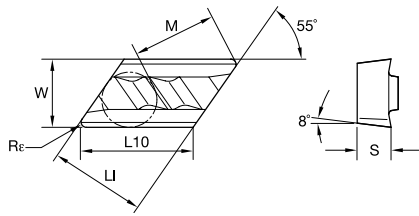
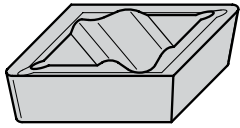

- Primär
- Sekundär

P	●
M	●
K	○
N	●
S	●
H	●

Top Notch™ Profildrehen • KCGR • NPGR

ISO	ANSI	L1		L10		W		S		M		Rε		KCP25C
Katalognummer	Katalognummer	mm	Zoll	mm	Zoll	mm	Zoll	mm	Zoll	mm	Zoll	mm	Zoll	
Rechtsausführung														
KCGR110304R08	NPGR51R	9.53	0.375	11.60	0.457	6.35	0.250	3.18	0.125	9.10	0.358	0.4	0.016	●
KCGR110308R08	NPGR52R	9.53	0.375	11.60	0.457	6.35	0.250	3.18	0.125	8.66	0.341	0.8	0.031	●
Linksausführung														
KCGR110304L08	NPGR51L	9.53	0.375	11.60	0.457	6.35	0.250	3.18	0.125	9.10	0.358	0.4	0.016	●
KCGR110308L08	NPGR52L	9.53	0.375	11.60	0.457	6.35	0.250	3.18	0.125	8.66	0.341	0.8	0.031	●

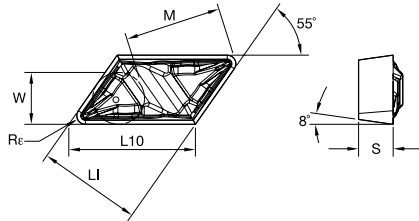

- Primär
- Sekundär

P	●
M	●
K	○
N	●
S	●
H	●

Top Notch™ Profildrehen • KCGR-FP • NPGR-FP

ISO	ANSI	L1		L10		W		S		M		Rε		KCP25C
Katalognummer	Katalognummer	mm	Zoll	mm	Zoll	mm	Zoll	mm	Zoll	mm	Zoll	mm	Zoll	
Rechtsausführung														
KCGR110304R08FP	NPGR51RFP	9.52	0.375	11.60	0.457	6.35	0.250	3.18	0.125	9.13	0.360	0.4	0.016	●
Linksausführung														
KCGR110304L08FP	NPGR51LFP	9.50	0.374	11.60	0.457	6.33	0.249	3.18	0.125	9.13	0.360	0.4	0.016	●
KCGR110308L08FP	NPGR52LFP	9.52	0.375	11.63	0.458	6.35	0.250	3.18	0.125	8.73	0.344	0.8	0.031	●

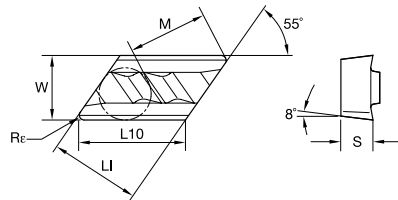
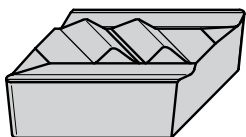

- Primär
- Sekundär

P	●
M	●
K	○
N	●
S	●
H	●

Top Notch™ Profildrehen • KCGX • NPR/L

ISO	ANSI	L1		L10		W		S		M		Rε		KCP25C
Katalognummer	Katalognummer	mm	Zoll	mm	Zoll	mm	Zoll	mm	Zoll	mm	Zoll	mm	Zoll	
Rechtsausführung														
KCGX110301R15	NPR505	9.57	0.377	11.60	0.457	6.33	0.249	3.18	0.125	9.47	0.373	0.1	0.005	●
KCGX110304R15	NPR51	9.57	0.377	11.60	0.457	6.33	0.249	3.18	0.125	9.15	0.360	0.4	0.016	●
KCGX110308R15	NPR52	9.57	0.377	-	-	6.33	0.249	3.18	0.125	8.69	0.342	0.8	0.031	●
Linksausführung														
KCGX110301L15	NPL505	9.53	0.375	11.60	0.457	6.35	0.250	3.18	0.125	9.43	0.371	0.1	0.005	●
KCGX110304L15	NPL51	9.53	0.375	11.60	0.457	6.35	0.250	3.18	0.125	9.11	0.359	0.4	0.016	●
KCGX110308L15	NPL52	9.57	0.377	-	-	6.33	0.249	3.18	0.125	8.69	0.342	0.8	0.031	●

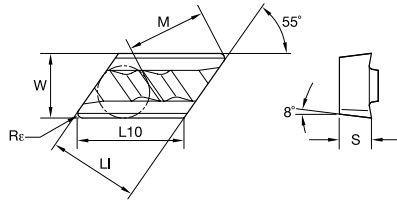
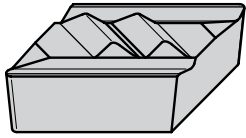

- Primär
- Sekundär

P	●
M	○
K	○
N	○
S	○
H	○

Top Notch™ Profildrehen • KCUX • NPR/L

ISO	ANSI	L1		L10		W		S		M		Rε		KCP25C
Katalognummer	Katalognummer	mm	Zoll	mm	Zoll	mm	Zoll	mm	Zoll	mm	Zoll	mm	Zoll	
Rechtsausführung														
KCUX110305R15L	NPR5M05L	9.50	0.374	11.60	0.457	6.33	0.249	3.18	0.125	9.06	0.357	0.5	0.020	●
Linksausführung														
KCUX110305L15	NPL5M05	9.53	0.375	11.60	0.457	6.35	0.250	3.18	0.125	9.06	0.357	0.5	0.020	●

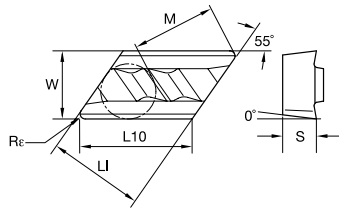
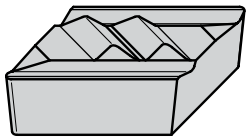

- Primär
- Sekundär

P	●
M	○
K	○
N	○
S	○
H	○

Top Notch™ Profildrehen • KNGX • NPR/L

ISO	ANSI	L1		L10		W		S		M		Rε		KCP25C
Katalognummer	Katalognummer	mm	Zoll	mm	Zoll	mm	Zoll	mm	Zoll	mm	Zoll	mm	Zoll	
Rechtsausführung														
KNGX150404R20	NPR131F	12.68	0.499	15.44	0.608	9.47	0.373	4.76	0.188	13.46	0.530	0.4	0.016	●
KNGX150408R20	NPR132F	12.68	0.499	15.44	0.608	9.47	0.373	4.76	0.188	12.99	0.512	0.8	0.031	●
Linksausführung														
KNGX150404L20	NPL131F	12.68	0.499	15.44	0.608	9.47	0.373	4.76	0.188	13.46	0.530	0.4	0.016	●
KNGX150408L20	NPL132F	12.65	0.498	15.44	0.608	9.47	0.373	4.76	0.188	12.99	0.512	0.8	0.031	●

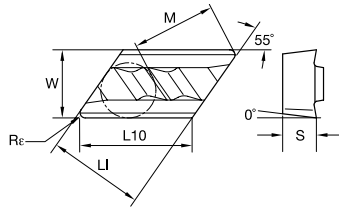
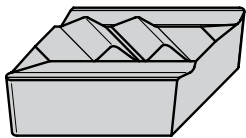

- Primär
- Sekundär

P	●
M	○
K	○
N	○
S	○
H	○

Top Notch™ Profildrehen • KNUX • NPR/L

ISO	ANSI	L1		L10		W		S		M		Rε		KCP25C
Katalognummer	Katalognummer	mm	Zoll	mm	Zoll	mm	Zoll	mm	Zoll	mm	Zoll	mm	Zoll	
KNUX150405L20	NPL13M05F	12.70	0.500	15.44	0.608	9.53	0.375	4.76	0.188	13.32	0.525	0.5	0.020	●

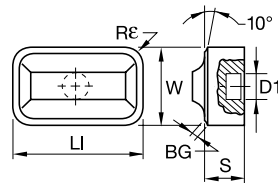

- Primär
- Sekundär

P	●
M	○
K	○
N	○
S	○
H	○

Eisenbahn-Räderbearbeitung • KRR-80

ISO	ANSI	W		L1		S		Rε		D1		KCP25C
Katalognummer	Katalognummer	mm	Zoll	mm	Zoll	mm	Zoll	mm	Zoll	mm	Zoll	
KRR658680	KRR658680	19.05	0.750	31.75	1.250	12.7	0.500	4.76	0.188	7.87	0.310	●

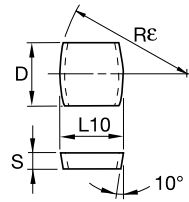

- Primär
- Sekundär

P	●
M	○
K	○
N	○
S	○
H	○

Eisenbahn-Räderbearbeitung • KRR-R

ISO	ANSI	D		L10		S		KCP25C
Katalognummer	Katalognummer	mm	Zoll	mm	Zoll	mm	Zoll	
KRR4210R	KRR4210R	12.70	0.500	12.70	0.500	3.18	0.125	●

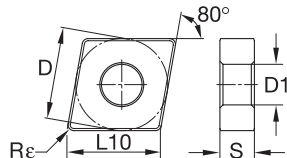
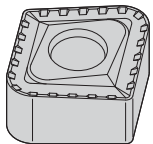

- Primär
- Sekundär

P	●
M	○
K	○
N	○
S	○
H	○

Eisenbahn-Räderbearbeitung • SNMX-WT5

ISO	ANSI	L10		S		Rε		D1		KCP25C
Katalognummer	Katalognummer	mm	Zoll	mm	Zoll	mm	Zoll	mm	Zoll	
SNMX190640S-WT5	SNMX190640S-WT5	19.05	0.750	6.35	0.250	4.0	0.158	6.35	0.250	●

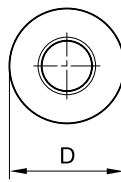
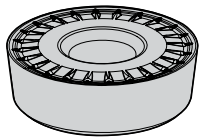

- Primär
- Sekundär

P	●
M	○
K	○
N	○
S	○
H	○

Eisenbahn-Räderbearbeitung • RCMH-Wendeschneidplatte • Positiv • UPG

ISO	ANSI	D		L10		R		KCP25C
Katalognummer	Katalognummer	mm	Zoll	mm	Zoll	mm	Zoll	
RCMH2507MOTUPG	RCMH2507MOTUPG	25.00	0.984	-	-	-	-	●
RCMH3209MOTUPG	RCMH3209MOTUPG	32.00	1.260	-	-	-	-	●

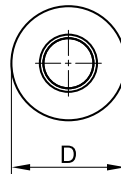
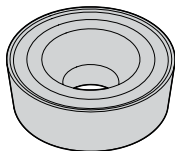

- Primär
- Sekundär

P	●
M	○
K	○
N	○
S	○
H	○

Eisenbahn-Räderbearbeitung • RCMH-Wendeschneidplatte • Positiv • K

ISO	ANSI	D		L10		R		KCP25C
Katalognummer	Katalognummer	mm	Zoll	mm	Zoll	mm	Zoll	
RCMH120400K	RCMH43K	12.70	0.500	-	-	-	-	●
RCMH190600K	RCMH64K	19.05	0.750	-	-	-	-	●
RCMH250900K	RCMH86K	25.40	1.000	-	-	-	-	●

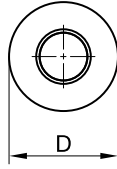
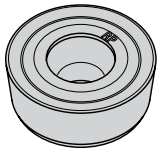

- Primär
- Sekundär

P	Blue	●
M	Yellow	○
K	Red	○
N	Green	○
S	Orange	○
H	Grey	○

Eisenbahn-Räderbearbeitung • RCMX-Wendeschneidplatte • Positiv

ISO	ANSI	D		L10		R		KGP25C
Katalognummer	Katalognummer	mm	Zoll	mm	Zoll	mm	Zoll	
RCMX2507M076	RCMX2507M076	25.00	0.984	-	-	-	-	●
RCMX3209M076	RCMX3209M076	32.00	1.260	-	-	-	-	●

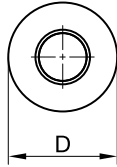

- Primär
- Sekundär

P	Blue	●
M	Yellow	○
K	Red	○
N	Green	○
S	Orange	○
H	Grey	○

Eisenbahn-Räderbearbeitung • RCMX-Wendeschneidplatte • Positiv • Rechts

ISO	ANSI	D		L10		R _e		KGP25C
Katalognummer	Katalognummer	mm	Zoll	mm	Zoll	mm	Zoll	
RCMX2507M0RH	RCMX2507M0RH	25.00	0.984	-	-	-	-	●
RCMX3209M0RH	RCMX3209M0RH	32.00	1.260	-	-	-	-	●

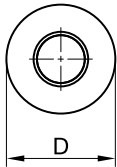
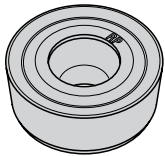

- Primär
- Sekundär

P	Blue	●
M	Yellow	○
K	Red	○
N	Green	○
S	Orange	○
H	Grey	○

Eisenbahn-Räderbearbeitung • RCMX-Wendeschneidplatte • Positiv • RP

ISO	ANSI	D		L10		R _e		KGP25C
Katalognummer	Katalognummer	mm	Zoll	mm	Zoll	mm	Zoll	
RCMX1003M0RP	RCMX1003M0RP	10.00	0.394	-	-	-	-	●
RCMX2507M0RP	RCMX2507M0RP	25.00	0.984	-	-	-	-	●

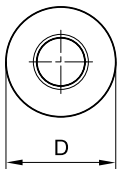
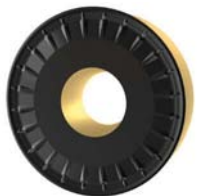

- Primär
- Sekundär

P	Blue	●
M	Yellow	○
K	Red	○
N	Green	○
S	Orange	○
H	Grey	○

Eisenbahn-Räderbearbeitung • RCMX Wendeschneidplatte • Positiv • UPG

ISO	ANSI	D		L10		R		KGP25C
Katalognummer	Katalognummer	mm	Zoll	mm	Zoll	mm	Zoll	
RCMX2507M0TUPG	RCMX2507M0TUPG	25.00	0.984	-	-	-	-	●
RCMX3209M0TUPG	RCMX3209M0TUPG	32.00	1.260	-	-	-	-	●

KENGold™

Der Goldstandard in der Beschichtungstechnologie



Die CVD-Sorte mit mehrlagiger KENGold-Beschichtung ist äußerst vielseitig bei der Bearbeitung von Stahl, ferritischen und martensitischen Edelstählen bei einer Vielzahl von Innen- und Außendrehanwendungen. Die Sorte zeichnet sich durch eine schwarze Spanfläche der Wendeschneidplatte und eine gleichmäßig über die Freifläche verlaufende, glatte Goldbeschichtung aus.

WERKZEUGAUSWAHLHILFE – STÄHLE

1. Schritt – Wahl der Wendeschneidplattengeometrie

Negative Wendeschneidplatten

1/2" Inkreis CNMG432

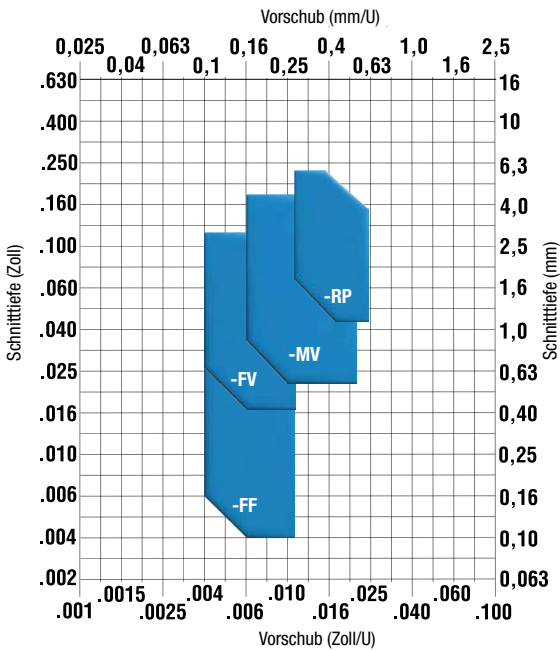

Positive Wendeschneidplatten

Größe 3 CCMT3252/CCGT3252

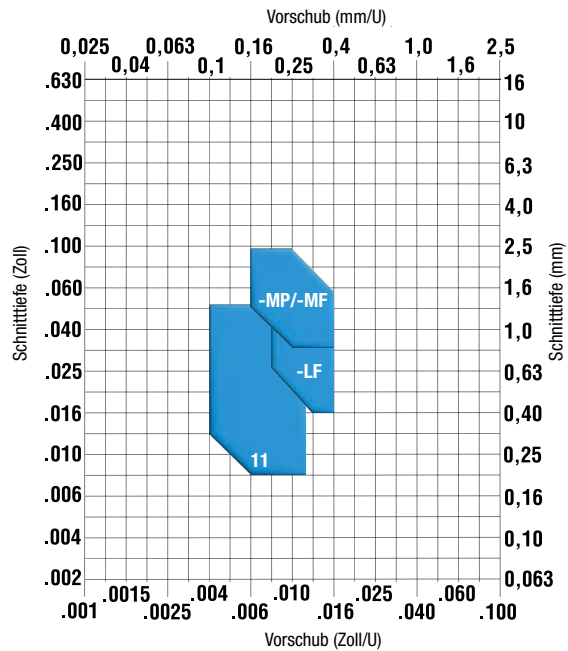

Negative Wendeschneidplatten								
1/2" Inkreis CNMG432								
	min. Vorschub		min. Schnitttiefe		max. Vorschub		max. Schnitttiefe	
	mm	Zoll	mm	Zoll	mm	Zoll	mm	Zoll
-FF	0,1	0.004	0,1	0.004	0,3	0.012	2,67	0.106
-FV	0,1	0.004	0,4	0.016	0,3	0.012	3	0.118
-FN	0,1	0.004	0,3	0.012	0,3	0.012	2,5	0.098
-MV	0,15	0.006	0,5	0.02	0,5	0.02	4,5	0.177
-MN	0,2	0.008	0,5	0.02	0,5	0.02	5,1	0.201
-MR	0,15	0.006	1	0.039	0,54	0.022	5,72	0.224
-RP	0,2	0.008	1,1	0.043	0,6	0.024	6,4	0.252
-RN	0,3	0.012	1,1	0.043	0,63	0.024	5,7	0.224

Positive Wendeschneidplatten								
Größe 3 CCMT3252/CCGT3252								
	min. Vorschub		min. Schnitttiefe		max. Vorschub		max. Schnitttiefe	
	mm	Zoll	mm	Zoll	mm	Zoll	mm	Zoll
-11	0,1	0.004	0,2	0.008	0,3	0.012	1,3	0.051
-UF	0,1	0.004	0,2	0.008	0,3	0.012	1,3	0.051
-HP	0,1	0.004	0,6	0.024	0,4	0.016	2,3	0.091
-LF	0,2	0.008	0,4	0.016	0,4	0.016	2,3	0.091
-FP	0,1	0.004	0,6	0.024	0,25	0.01	2	0.079
-MP / -MF	0,15	0.006	0,8	0.031	0,4	0.016	2,5	0.098

2. Schritt – Wahl der Sorte

Negative Wendeschneidplatten-Geometrie									
Schnittbedingung	-CT	-FF	-FV	-FN	-MV	-MN	-MR	-RP	-RN
Stark unterbrochener Schnitt	-	KCP10B/ KCP10	KCP25C	KCP25C	KCP40B	KCP30B/ KCP40B	KCP30B	KCP30B/ KCP40B	KCP30B/ KCP40B
Leicht unterbrochener Schnitt	-	KCP10B/ KCP10	KCP10B	KCP25C	KCP25C	KCP25C	KCP25C	KCP25C	KCP25C
Schwankende Schnitttiefe, Guss- oder Schmiedehaut	KCP10B	KCP05B/ KCU10B/ KTP10/ KT315	KCP10B	KCP10B	KCP10B	KCP10B	KCP10B/ KCU10B	KCP10B/ KCU10B	KCP10B/ KCU10B
Glatter Schnitt, vorgedrehte Oberfläche	KCP05	KCP05B	KCP05B	KCP05B/ KCP05/ KCP10B	KCPK05	KCP05B/ KCP10B	KCP10B/ KCP10/ KCK15B	KCP05B/ KCPK05	KCP05B
glatter Schnitt, hohe Präzision/enge Toleranz	KCU10	KCU10B/ KTP10/ KT315	KTP10/ KT315	KCU10B/ KTP10/ KT315	-	-	KCU10B	KCU10B	KCU10B

Positive Wendeschneidplatten-Geometrie						
Schnittbedingung	-11	-UF	-LF	-FP	-MF	-MP
Stark unterbrochener Schnitt	-	KCP25C/ KCU10B	KCP25C/ KCP30B/ KCP40B	KCP25C	KCP25C/KCP30B	-
Leicht unterbrochener Schnitt	-	KCP25C/ KCU10B	KCP25C	KCP25C	KCP25C	KCP25C
Schwankende Schnitttiefe, Guss- oder Schmiedehaut	KTP10/ KT315	KCP10B	KCU10B	KCP10B/ KCU10B	KCP10B	KCU10B/ KCP10
Glatter Schnitt, vordrehte Oberfläche	KTP10/ KT315	KCP05B	KCP05B	KCP05B/ KCP10B	KCP10B	-
glatter Schnitt, hohe Präzision/enge Toleranz	KTP10/ KT315	-	KCU10B	KCU10B/ KTP10/ KT315	-	KCU10B

HINWEIS: Wenn mehrere Sorten gezeigt werden, ist die erste Wahl fettgedruckt.

1. Schritt – Wahl der Wendeschneidplattengeometrie

Negative Schlichtplatten

1/2 Zoll IC CNMG432

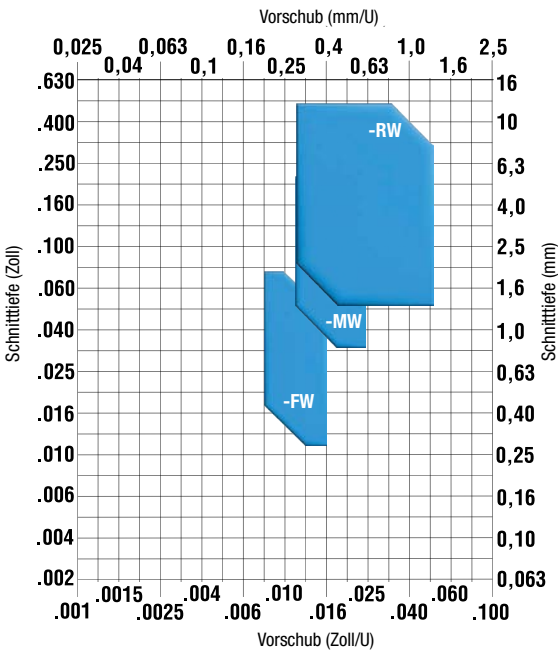

Positive Schlichtplatten

Größe 3 CCMT3252/CCGT3252

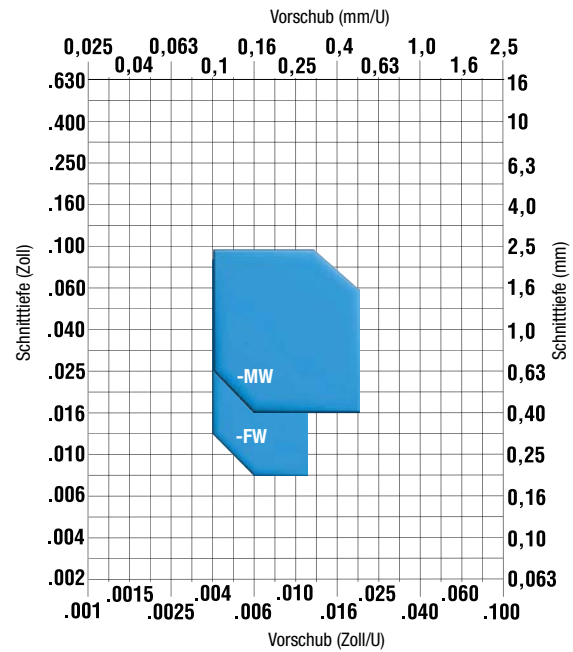

Negative Wiper Breitschicht-Wendeschneidplatten								
1/2" Inkreis CNMG432								
	min. Vorschub		min. Schnitttiefe		max. Vorschub		max. Schnitttiefe	
	mm	Zoll	mm	Zoll	mm	Zoll	mm	Zoll
-FW	0,2	0.008	0,3	0.012	0,4	0.016	2	0.079
-MW	0,3	0.012	0,8	0.031	0,6	0.024	5,1	0.201
..MM-RW	0,3	0.012	1,3	0.051	1,3	0.051	12,7	0.5

Positive Wiper Breitschicht-Wendeschneidplatten								
Größe 3 CCMT3252/CCGT3252								
	min. Vorschub		min. Schnitttiefe		max. Vorschub		max. Schnitttiefe	
	mm	Zoll	mm	Zoll	mm	Zoll	mm	Zoll
-FW	0,1	0.004	0,2	0.008	0,3	0.012	2,3	0.091
-MW	0,1	0.004	0,4	0.016	0,5	0.02	2,5	0.098

2. Schritt – Wahl der Sorte

WIPER	Negative Wendeschneidplatten-Geometrie		
Schnittbedingung	-FW	-MW	-RW
Stark unterbrochener Schnitt	-	KCP25C	KCP25C
Leicht unterbrochener Schnitt	KCP10B/ KCP10	KCP25C	KCP25C
Schwankende Schnitttiefe, Guss- oder Schmiedehaut	KCP10B/ KCP10	KCP25C/ KCP10B/ KCP10	KCP25C
Glatte Schnitt, vorgedrehte Oberfläche	KCP05B/ KCP05	KCP05B/ KCP05	-
glatter Schnitt, hohe Präzision/enge Toleranz	KCU10B/KTP10/ KT315	-	-

HINWEIS: Wenn mehrere Sorten gezeigt werden, ist die erste Wahl **fettgedruckt**.

WIPER	Positive Wendeschneidplatten-Geometrie	
Schnittbedingung	-FW	-MW
Stark unterbrochener Schnitt	KCP25C	KCP25C
Leicht unterbrochener Schnitt	KCP25C	KCP25C
Schwankende Schnitttiefe, Guss- oder Schmiedehaut	KCP25C/KCP10B/ KCP10	KCP25C/KCP10B/ KCP10
Glatte Schnitt, vorgedrehte Oberfläche	KCP10B/ KCP10	KCP10B/ KCP10
glatter Schnitt, hohe Präzision/enge Toleranz	KCU10B/KTP10/ KT315	KCU10B/KTP10/ KT315

1. Schritt – Wahl der Wendeschneidplattengeometrie

Negative Schwerzerspanungs-Wendeschneidplatten

3/4" Inkreis CNMM644

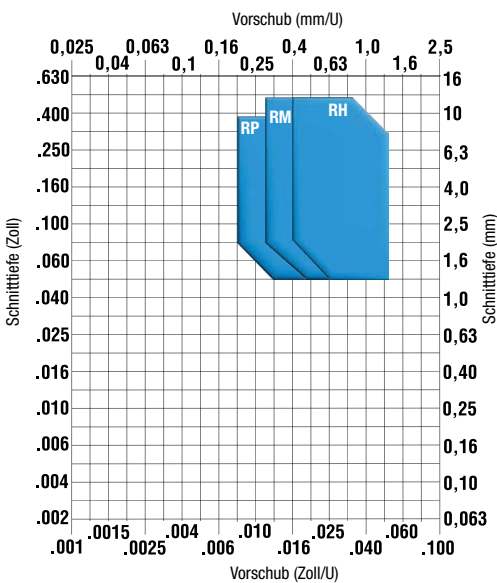

Positive Schwerzerspanungs-Wendeschneidplatten

RCMX32

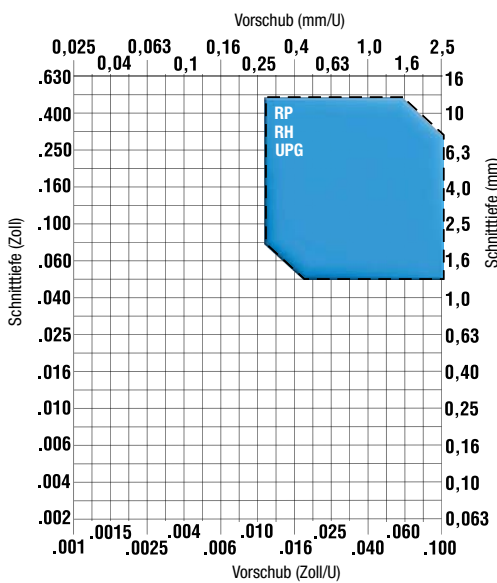

Negative Schwerzerspanungs-Wendeschneidplatten								
3/4" Inkreis CNMM644								
	min. Vorschub		min. Schnitttiefe		max. Vorschub		max. Schnitttiefe	
	mm	Zoll	mm	Zoll	mm	Zoll	mm	Zoll
-RP	0,2	0.008	1,28	0.05	1,3	0.051	10	0.394
-RM	0,3	0.012	1,28	0.05	1,3	0.051	12,7	0.5
-RH	0,4	0.016	1,28	0.05	1,3	0.051	12,7	0.5

Positive Schwerzerspanungs-Wendeschneidplatten								
RCMX32								
	min. Vorschub		min. Schnitttiefe		max. Vorschub		max. Schnitttiefe	
	mm	Zoll	mm	Zoll	mm	Zoll	mm	Zoll
-UPG	0,3	0.012	1,3	0.051	2,56	0.102	12,8	0.504
-RP	0,3	0.012	1,3	0.051	2,56	0.102	12,8	0.504
-RH	0,3	0.012	1,3	0.051	2,56	0.102	12,8	0.504

2. Schritt – Wahl der Sorte

Schruppbearbeitung	Negative Wendeschneidplatten-Geometrie		
Schnittbedingung	-RP	-RM	-RH
Stark unterbrochener Schnitt	KCP30B/KCP30/ KCP40B/KCP40	KCP30B/KCP30/ KCP40B/KCP40	KCP30B/KCP30/ KCP40B/KCP40
Leicht unterbrochener Schnitt	KCP25C/KCP30B/ KCP30	KCP25C/KCP30B/ KCP30	KCP25C/KCP30B/ KCP30
Schwankende Schnitttiefe, Guss- oder Schmiedehaut	KCP25C/KCP10B/ KCP10	KCP25C/KCP10B/ KCP10	KCP25C/KCP10B/ KCP10
Glatte Schnitt, vorgedrehte Oberfläche	KCP10B/KCP10	KCP10B/KCP10	KCP10B/KCP10

HINWEIS: Wenn mehrere Sorten gezeigt werden, ist die erste Wahl **fettgedruckt**.

Schruppbearbeitung	Positive Wendeschneidplatten-Geometrie		
Schnittbedingung	-UPG	-RP	-RH
Stark unterbrochener Schnitt	KCP30B/KCP30/ KCP40B/KCP40	KCP30B/KCP30/ KCP40B/KCP40	-
Leicht unterbrochener Schnitt	KCP25C/KCP30B/ KCP30	KCP25C/KCP30B/ KCP30	KCP25C/KCP30B/ KCP30
Schwankende Schnitttiefe, Guss- oder Schmiedehaut	KCP25C/KCP10B/ KCP10	KCP25C/KCP10B/ KCP10	KCP25C/KCP10B/ KCP10
Glatte Schnitt, vorgedrehte Oberfläche	KCPK05/KCP10B/ KCP10	KCP10B/KCP10	KCP10B/KCP10

3. Schritt – Wahl der Schnittgeschwindigkeit

Stahl mit geringem Kohlenstoffgehalt (<0,3 % C) und Automatenstahl		m/min			SFM		
Werkstoffgruppe	Beschichtungen	MIN.	START	MAX.	MIN.	START	MAX.
P0/P1	KTP10/KT315	180	440	475	590	1440	1560
	KCU10B	165	310	395	540	1020	1300
	KCP05B/KCP05/KCPK05	180	435	500	590	1430	1640
	KCP10B/KCP10	180	395	440	590	1300	1440
	KCP25C	150	330	430	490	1080	1410
	KCP30B/KCP30/KCP40B/KCP40	115	210	235	380	690	770

Stähle mit mittlerem und hohem Kohlenstoffgehalt (>0,3 % C)		m/min			SFM		
Werkstoffgruppe	Beschichtungen	MIN.	START	MAX.	MIN.	START	MAX.
P2	KTP10/KT315	190	270	395	620	890	1300
	KCU10B	155	220	250	510	720	820
	KCP05B/KCP05/KCPK05	180	240	400	590	790	1310
	KCP10B/KCP10	180	265	350	590	870	1150
	KCP25C	150	235	385	490	770	1260
	KCP30B/KCP30/KCP40B/KCP40	115	150	240	380	490	790

Legierte Stähle und Werkzeugstähle; <330 HB; <35 HRC		m/min			SFM		
Werkstoffgruppe	Beschichtungen	MIN.	START	MAX.	MIN.	START	MAX.
P3	KTP10/KT315	180	210	275	590	690	900
	KCU10B	150	170	250	490	560	820
	KCP05B/KCP05/KCPK05	180	205	275	590	670	900
	KCP10B/KCP10	160	190	245	520	620	800
	KCP25C	150	185	275	490	610	900
	KCP30B/KCP30/KCP40B/KCP40	115	120	160	380	390	520

Legierte Stähle und Werkzeugstähle; 350–450 HB; 35–48 HRC		m/min			SFM		
Werkstoffgruppe	Beschichtungen	MIN.	START	MAX.	MIN.	START	MAX.
P4	KTP10/KT315	90	210	215	300	690	710
	KCU10B	85	120	195	280	390	640
	KCP05B/KCP05/KCPK05	90	155	215	300	510	710
	KCP10B/KCP10	90	145	195	300	480	640
	KCP25C	75	125	215	250	410	710
	KCP30B/KCP30/KCP40B/KCP40	50	95	135	160	310	440

Ferritische, martensitische und nicht rostende PH-Stähle; <330 HB; <35 HRC		m/min			SFM		
Werkstoffgruppe	Beschichtungen	MIN.	START	MAX.	MIN.	START	MAX.
P5	KTP10/KT315	150	250	310	490	820	1020
	KCU10B	130	220	290	430	720	950
	KCP05B/KCP05/KCPK05	150	230	270	490	750	890
	KCP10B/KCP10	150	215	300	490	710	980
	KCP25C	130	235	325	430	770	1070
	KCP30B/KCP30/KCP40B/KCP40	110	135	150	360	440	490

Ferritische, martensitische und nicht rostende PH-Stähle; 350–450 HB; 35–48 HRC		m/min			SFM		
Werkstoffgruppe	Beschichtungen	MIN.	START	MAX.	MIN.	START	MAX.
P6	KTP10/KT315	140	200	295	460	660	970
	KCU10B	115	165	250	380	540	820
	KCP05B/KCP05/KCPK05	140	200	300	460	660	980
	KCP10B/KCP10	120	180	270	390	590	890
	KCP25C	115	180	265	380	590	870
	KCP30B/KCP30/KCP40B/KCP40	90	105	140	300	340	460



Sie benötigen Schnittgeschwindigkeit und Vorschub?

Besuchen Sie kennametal.com/NOVO, um spezifische
Schnittdaten für Ihre Anwendung zu erhalten!

Wir zerspanen Metall Seit 1938.



Unsere Geschichte ist die einer kontinuierlichen Innovation

Sie beginnt 1938 mit unserem Gründer, dem Metallurgen Philip M. McKenna, der nach jahrelanger Forschung eine Wolfram-Titan-Hartmetalllegierung eigens für Schneidwerkzeuge entwickelte. Diese eine Entwicklung hat nicht nur zu einer neuen Klasse von Zerspanungswerkzeugen geführt, die schneller schneiden, länger halten und die Produktivität in allen Bereichen steigern, angefangen beim Automobil bis hin zum Flugzeug, sondern auch zur Eröffnung der McKenna Metals Company in Latrobe, Pennsylvania, USA. Heute heißt dieses Unternehmen Kennametal Inc. und ist ein anerkannter Marktführer im Bereich Metallbearbeitung, der Kunden auf allen Kontinenten und in Branchen bedient wie Transport, Bauwesen, Luft- und Raumfahrt, spanabhebende Bearbeitung, Energie und allg. Maschinenbau. Wir sind für die Entwicklung innovativer Lösungen für die anspruchsvollsten Anwendungen unserer Kunden bekannt. Der Name Kennametal steht für hochwertige und hoch leistungsfähige Werkzeuge, die anspruchsvollsten Bedingungen standhalten und eine Vielzahl von Bearbeitungsoperationen erleichtern. Mit unserer Hilfe können unsere Kunden produktiver, schneller und präziser arbeiten. Wir nehmen die Herausforderung an. Wir zerspanen Metall. Auch anspruchsvollste Werkstoffe haben keine Chance.

KCP25C



**Zuverlässige
Leistung
beim Drehen**



©2024 Kennametal Inc. | Alle Rechte vorbehalten. | 210949-24

**LASSEN SIE UNS IHRE PRODUKTION
AUF DIE NÄCHSTE EBENE BRINGEN**

[kennametal.com/KCP25C](https://www.kennametal.com/KCP25C)